



PUBLISHED BY THE SERRA MESA COMMUNITY COUNCIL

VOLUME 32, ISSUE 2 MARCH / APRIL 2018

Serra Mesa Village



www.SerraMesa.org

You are invited to participate in the

Serra Mesa Community Council

Wednesday, March 28

6:30 p.m.

*Serra Mesa - Kearny Mesa Library
Community Room, 9005 Aero Drive*

Serra Mesa Community Council

Wednesday, April 25

6:30 p.m.

*Serra Mesa - Kearny Mesa Library
Community Room, 9005 Aero Drive*

Neighborhood People
and Friendly Businesses
Living and Working Together

See page 14 and Calendar Insert for more information!

Serra Mesa Community Council Board**Officers**

Carl Demas.....	(858) 565-2473*
<i>President</i>	
Andrea Eaton.....	(858) 565-2473*
<i>Treasurer/Community Events</i>	
Cindy McIntyre	(858) 565-2473*
<i>Secretary</i>	

Board Members

Jackie Ander.....	(858) 565-2473*
<i>Friends of the Library</i>	
Andrea Eaton.....	(858)565-2473*
<i>Community Events</i>	
Jon Cima.....	(858)565-2473*
<i>SMRC</i>	
Cindy McIntyre.....	(858)565-2473*
<i>Education Committee</i>	
Tom Leech.....	(858)565-2473*
<i>Current Issues</i>	
Cindy Moore.....	(858)565-2473*
<i>Special Projects/SMPG</i>	
Kimberly Lieu/Diana Wendel.....	(858)565-2473*
<i>Farmers Market</i>	
Jennifer St. Clair.....	(858)565-2473*
<i>Pantry, Garden, Village Coordinator</i>	
Terry O'Regan.....	(858)565-2473*
<i>Local Business Coordinator</i>	

Appointed Positions

Myra Webb.....	(858)565-2473*
<i>Subscription Records</i>	
Ronda Adams.....	(858)565-2473*
<i>Observer Editor</i>	
Melissa Cima.....	(858)565-2473*
<i>Observer Staff/Education</i>	
Cindy McIntyre.....	(858)565-2473*
<i>Observer Staff</i>	
Marge Demas.....	(858)565-2473*
<i>Mailing Coordinator</i>	
Carl Demas.....	(858)565-2473*
<i>Message Coordinator</i>	
Cindy Moore.....	(858)565-2473*
<i>Utility Box Coordinator</i>	

*Contact by calling (858) 565-2473 & leaving a message.

SERRA MESA COMMUNITY GROUPS

Serra Mesa Community Council	(858) 565-2473
e-mail: communitycouncil@serramesa.org	
Serra Mesa Planning Group	(858) 565-2473
e-mail: smpg@serramesa.org	

ELECTED OFFICIALS

Board of Education Kevin Beiser	(619) 725-5550
City Councilmember Scott Sherman	(619) 236-6677
Mayor Kevin Faulconer	(619) 236-6330
County Supervisor Ron Roberts	(619) 531-5544
State Assembly Member Shirley N. Weber	(619) 531-7913
State Senator Toni G. Atkins	(619) 645-3133
Governor Jerry Brown	(619) 525-4641
U.S. Representative Susan Davis	(619) 280-5353
U.S. Senator Dianne Feinstein	(619) 231-9712

CALENDAR OF COMING EVENTS

Mar 13	Friends of Serra Mesa-Kearny Mesa Library 5:30 p.m., Serra Mesa-Kearny Mesa Library, Sudberry Room
Mar 15	Serra Mesa Village Connection 3:30 p.m., Serra Mesa-Kearny Mesa Library, Community Room
Mar 15	Serra Mesa Planning Group 7 p.m., Serra Mesa-Kearny Mesa Library, Community Room
Mar 17	Hearing Loss Association of America (San Diego) 10:30 a.m., Mission Village Christian Fellowship
Mar 20	Serra Mesa Recreation Center Council Meeting 6:30 p.m., 9020 Village Glen Drive
Mar 28	Friends of Ruffin Canyon 5:30 p.m., Serra Mesa-Kearny Mesa Library, Community Rm
Mar 28	Serra Mesa Community Council 6:30 p.m., Serra Mesa-Kearny Mesa Library, Community Rm
Apr 7	Friends of Ruffin Canyon Cleanup 9:00 a.m., Shawn Avenue entrance to Ruffin Canyon
Apr 17	Serra Mesa Recreation Center Council Meeting 6:30 p.m., 9020 Village Glen Drive
Apr 19	Serra Mesa Village Connection 3:30 p.m., Serra Mesa-Kearny Mesa Library, Community Room
Apr 19	Serra Mesa Planning Group 7 p.m., Serra Mesa-Kearny Mesa Library, Community Room
Apr 21	Hearing Loss Association of America (San Diego) 10:30 a.m., Mission Village Christian Fellowship
Apr 25	Friends of Ruffin Canyon 5:30 p.m., Serra Mesa-Kearny Mesa Library, Community Rm
Apr 25	Serra Mesa Community Council 6:30 p.m., Serra Mesa-Kearny Mesa Library, Community Rm
May 5	Friends of Ruffin Canyon Cleanup 9:00 a.m., Shawn Avenue entrance to Ruffin Canyon

*Serra Mesa Enhancement Committee meetings -
write to P.O. Box 23315, San Diego, CA, 92193.*

In This Issue...

SMCC Community Forums	1
Community Phone Numbers, Calendar	2
President's Message	3
KUDOS - Bear Buns	4
Free Classes SDCE, SM Rec Center,	5
Continuing Education	6
Important Phone Numbers	7
Kearny High Update	8
Serra Mesa-Kearny Mesa Branch Library	9
Serra Mesa Planning Group	12
SMCC New and Renewed Members	13
Franklin Ridge Road Update, Serra Mesa Village	14
Serra Mesa Housing History	15
Serra Mesa Recreation Egg Scramble	18
SMCC Subscription App/Renewal	19
Serra Mesa Village Calendar	Inserts

Serra Mesa Observer is published bimonthly by the

Serra Mesa Community Council with a circulation of approx 800

Annual fees: Household...\$15 Sponsor...\$25 Benefactor...\$50

For subscriptions and ads, call (858) 565-2473 Council doesn't endorse ads.

Articles, Ideas, & Upcoming Events for the Observer

are welcome. Editor reserves right to edit articles.

For articles, e-mail Ronda Adams - rondakadams@msn.com

Deadline: May / June Edition...April 22nd

P.O. Box 23315, San Diego, CA, 92193

<http://www.serramesa.org> communitycouncil@serramesa.org

PRESIDENT'S MESSAGE



You are needed!

It is an exciting time to be living in San Diego. As they say, "We live in interesting times". Recently I was looking at some demographics for Serra Mesa with the following results: Population – 30,387; Median Age – 32.6; Households – 10,039; Persons per household – 2.57; Income per household – 72,245; Number of businesses – 1752; Number of employees – 82,329; Median house value – 442,800. So, what does all this mean? I always thought that we were this little community surrounded by canyons. A bedroom community with very little business and homeowners who worked all day and only returned to lock themselves in their homes. Shows how wrong I was.

It turns out that we are a significant part of San Diego and should take stock of who we are and what we can expect from those who care what we think and want. We are a significant part of the revenue that is sent to our City, County, State, and Federal Government. We have been ignored long enough and it is high time that we let our needs and wants to be heard. So now that we have stated our importance what is it that we want. What are some of the needs and concerns of our neighborhood? At our Council Meetings and various places where we congregate, we hear of the need for a local grocery store where we can shop with reasonable prices and selection without having to drive 5 miles to get there. Sorry but CVS just doesn't have it. At least we can get a few needed items, but it should be nice to shop at a local place where those who do not drive can

walk and pick up what they need. We tried a Farmer's Market for the last year and while it started out with a bang, a lack of shoppers and the price of local farmer's produce soon found our market barren because of lack of participation. Our Farmer's Market manager fulfilled his contract for a year and if it was successful, it would still be here.

The homeless is another concern and seems to be a growing problem throughout our City, State, and Nation. Pan Handling has become a local profession and there is hardly a corner around anymore without some individual with their hand out looking for money. Will work for food is no longer an option, they just want cash. When will we learn to stop supporting drug and alcohol habits and donate instead to agencies that are working on the situation? Our local police are faced with sending resources to the worst neighborhoods and thankfully we are not one of them. Resources to our area suffer until law reinforcement is stabilized. Thank goodness we have increased law enforcement pay so we can retain and attract new officers. We have an ear with Officer Tom Bostedt and Lt. Brown who attend each Community Council Meeting. Get a monthly report or ask about a specific problem.

Okay, so where am I going with this? The Serra Mesa Community Council is the answer, but we need your participation and assistance. Together we can solve our problems or at least make them known to those who can assist us. Our local elected officials except for Tony Atkins, who will be speaking at our March 28th Meeting, do not even come to our Council Meetings as they are too involved in "more important issues". People we need to stand together to get the respect we want. Don't like the topics at the meeting, tell us what you want. We are desperate to help the community solve some of our problems. We are the place where you can come and voice your frustrations as to what is wrong and what is right with Serra Mesa. I think we are the crown jewel of San Diego. Everything about us is positive we have a location, accessibility, and a great place to live. It just doesn't happen. Support our local Community Meetings on the 4th Wednesday, our Public Library, our Schools, our Recreation Center, our local businesses, and your local church, synagogue or mosque. We all need you!

Carl Demas, President SMCC

BEAR BUNS HAS NEW LEADERSHIP TEAM



Bear Buns Bakery & Cafe is a popular spot for coffee and munchies located on Greyling next to the Serra Mesa Post Office. It's a good hangout for neighbors to gather for refreshments and conversations.

Several years ago, the management team of Todd and Richard took over the operation and has had good success in enhancing the appearance and food options.

On March 3rd a new ownership team, with direct ties to the previous owners, will take over. Ashli Valdez has been the Bear Buns Baker for two years, part of a 13-year career as a baker. Michi Sowers for the past year has been the cafe's Lead Barista, managing the front desk and customer services of food and drinks. They will continue performing those duties and Johnny Valdez, Ashli's husband, is the 3rd new owner as a silent partner. Ashli and Michi are native San Diegans, growing up in Lemon Grove and graduating from Helix High School.

The close connection between new and previous owners was a key factor in the change. Per Ashli: "They wanted someone to keep the same concept, and Michi and I want that also. There'll be no big changes as we'll continue providing delicious cinnamon rolls, muffins, and sticky buns along with coffee and beverages."

Bear Buns is right next to the Serra Mesa Post Office at 3251 Greyling, just north of Sandroek. They open at 6 a.m. and close at 6 p.m. (Sunday 7 a.m. -4 p.m.), and serve food offerings to match breakfast, lunch and early dinner. For specifics check mybearbuns.com or call 858-573-2327.

~~~~~

Tom Leech is a frequent Observer contributor and a member of the SM Community Council Board and the SM Park & Rec Committee. He's the author of many books, including *On the Road in '68: a Year of Turmoil, a Journey of Friendship*. For info visit [www.presentationpress.com](http://www.presentationpress.com).

.....

### Gethsemane Lutheran Church



Karin Boye  
Interim Pastor

[rev.karin@yahoo.com](mailto:rev.karin@yahoo.com)  
[www.gethsemanesd.org](http://www.gethsemanesd.org)

2696 Melbourne Drive  
San Diego, CA 92123

Worship 8:00, 9:30 am  
(858) 277-6572

Endodontics      Crowns      Cosmetics  
Prosthodontics      Implants

**WILLIAM E. LARSON, D.M.D.**  
AERO DENTISTRY

3755 Murphy Canyon Rd. #D  
San Diego, CA 92123

Tel: (858) 277-2999  
Fax: (858) 277-3086



*Improve* your home.  
*Improve* your bottom line.

Jason LaMell | Broker  
619.300.5697  
www.improvereadtyus.com  
CalBRE#01861043

*Instead of selling  
your home "As-is",  
let us remodel to get  
you more money!*

- We **remodel** your home
- We **sell** it fast
- You keep the **profit**  
(No out-of-pocket costs)

Put our expertise to work  
for you! Call to find out  
how. 619.300.5697

## Serra Mesa Recreation Center

9020 Village Glen Dr.  
(858) 573-1408

1:00 - 8:00 p.m. Monday, Tuesday, Thursday  
1:00 - 9:00 p.m. Wednesday  
2:00-6:00 p.m. Friday  
10:00 a.m. - 4:00 p.m. Saturday  
Closed Sunday.

### Community Sports Information:

A.Y.S.O. Soccer: (858) 268-5880  
N.Y.S. Soccer : (858) 973-6101  
SD United Soccer: (858) 457-4625  
Serra Mesa Senior Softball:  
(858) 279-4283

Serra Mesa Little League: (858) 279-8361

Serra Mesa Recreation Council meets on  
March 20 & April 17 at 6:30 p.m.

# FREE CAREER TRAINING



SAN DIEGO CONTINUING EDUCATION

**sdce.edu**



## Continuing Education leads the way for Entry-Level Medical Jobs



SDCE student at Cesar E. Chavez Campus in Barrio Logan

By: Allura Garis

Spring semester at San Diego Continuing Education (SDCE) is underway and healthcare career training is at its highest level of enrollment.

The healthcare industry is growing faster than ever due to recent changes in the United States' healthcare system. With this growth comes the demand for higher education and skilled workers.

SDCE offers free short-term healthcare career training to San Diego county residents 18+. While registered nursing programs can take minimally two to four years to complete, SDCE's Certified Nursing Assistant program can be generally completed in 260 hours or sixteen weeks.

Additional certifications include Personal Care Assistant/Caregiver and Home Health Aide.

"No one in my family has a high school diploma. This is a big deal for me. I want to show my daughter even if you have a big setback if you really fight for it you can do it," said Susana, SDCE student. Many students like Susana transition regularly from SDCE's Cesar E. Chavez Campus to City College to begin nursing classes.

"We are teaching students to envision earning beyond minimum or low wages, said Carlos O. Turner Cortez, Ph.D., SDCE President. "We are moving full force. We encourage SDCE students to earn income while they are learning and providing paid internships is a successful model."

Last year SDCE awarded nearly 10,000 diplomas and certificates of completion, an increase of 66% from the previous year.

Spring semester classes and free certificate programs at SDCE are currently enrolling. For more information visit, [SDCE.EDU](http://SDCE.EDU)

## **IMPORTANT PHONE NUMBERS**

|                                              |                |                                         |                |
|----------------------------------------------|----------------|-----------------------------------------|----------------|
| Abandoned Vehicles &                         |                | Police Department - Eastern Division    | (858) 495-7900 |
| Police Non-Emergency                         | (619) 531-2000 | Post Office                             | (800) 275-8777 |
| Airport Noise - Montgomery Airfield          | (858) 573-1436 | Poison Control Center                   | (800) 876-4766 |
| Animal Control                               | (619) 767-2675 | Rape /Domestic Violence Hotline         | (858) 272-1767 |
| Bus & Trolley Schedules                      | (619) 233-3004 | RSVP (Retired Seniors Volunteer Patrol) | (858) 495-7990 |
| Canyon Cleanup                               | (619) 533-4411 | SDG&E Emergencies                       | (800) 411-7343 |
| Child Abuse Hotline                          | (858) 560-2191 | Senior Citizen Services                 | (619) 236-6905 |
| City Clerk - Docket Information              | (619) 533-4000 | Serra Mesa Library                      | (858) 573-1396 |
| Crime - General Business                     | (619) 531-2000 | Serra Mesa Recreation Center            | (858) 573-1408 |
| Crime Stoppers                               | (619) 235-8477 | Sidewalk Repair                         | (619) 527-7500 |
| Dead <b>Animal</b> Removal stay on the line) | (858) 694-7000 | Stadium Manager                         | (619) 641-3101 |
| Emergency Information - Earthquake           | (858) 565-3490 | Stadium Security & Noise                | (619) 641-3150 |
| Fallen Trees                                 | (858) 527-7500 | Stolen Property/Bicycles - To Report    | (619) 531-2000 |
| Fire Department - Non-emergency              | (619) 533-4300 | Storm Drain Misuse                      | (619) 235-1000 |
| Flies & Vermin                               | (858) 694-2888 | Street Repair - Faded signs, pavement   | (619) 527-7500 |
| Graffiti                                     | (619) 525-8522 | Traffic Signal Maintenance              | (619) 527-8650 |
| Hazardous Chemicals & Waste                  | (858) 694-7000 | Water Emergencies - City & Private      | (619) 515-3525 |
| Health Violations                            | (619) 338-2222 | Weeds                                   | (619) 533-4444 |
| Kearny High Alumni Association               | (619) 699-0886 | Zoning/Permits - Questions & Violations | (619) 446-5000 |
| Litter - City Owned/Private Property         | (858) 492-5055 |                                         |                |
| Meals On Wheels                              | (619) 260-6110 |                                         |                |
| Neighborhood Code Compliance                 | (619) 236-5500 |                                         |                |
| Barking Dogs, Code Violations, Noise, Safety |                |                                         |                |



**\*From Concept to Completion\***  
 18 years strong Serra Mesa  
 Video Production Company  
 Venue Filming\*Music Video Production\*Video Montages  
 Media/Marketing Relations  
 Ask for Liz: [emlmedia@yahoo.com](mailto:emlmedia@yahoo.com)

**Marvin Sloben**  
 Photographer  
**619.239.2828**  
[Msloben@san.rr.com](mailto:Msloben@san.rr.com)

3026 North Park Way • San Diego, CA 92104

**Holy Angels Byzantine Catholic Church**  
 2235 Galahad Road, San Diego, CA 92123

**Divine Liturgy on Sunday at 9 a.m.**

**Eastern European Ethnic Foods**

**Available in the Church Hall**  
 Open 10 a.m. to 2 p.m.—Friday-Tuesday  
 Closed on Wednesday and Thursday  
 Please call before coming for the food.  
 858-268-3458



**St. Columba Parish**

3327 Glencolum Drive

San Diego, CA 92123

(858) 277-3863

[www.stcolumbasandiego.com](http://www.stcolumbasandiego.com)

|             |                                     |
|-------------|-------------------------------------|
| Sunday Mass | 7:30, 9:30 a.m. & 5:30 p.m.         |
| Saturday    | 8:00a.m.&5:30p.m.                   |
| Mon-Thurs.  | 7:00 a.m.                           |
| Fri.        | 8:15 a.m.                           |
| Holy Days   | Please call the church for schedule |

## THE “NEW” KEARNY HIGH SCHOOL

Did you know that Kearny High is composed of four small specialty schools? In 2004, Kearny closed and reopened as the Kearny High Educational Complex. Kearny’s four small schools are: The School of Digital Media and Design (DMD), The School of College Connections (SCC), The School of Engineering, Innovation, and Design (EID), and The School of Science, Connections & Technology (SCT). Each school is contained in a relatively separate area of the site. Shared spaces include the complex office, auditorium, gymnasium, library, student center, locker rooms, athletic facilities, and cafeteria. All schools operate on the same academic calendar and bell schedule. There is one principal who oversees all four small schools, and three of the four schools have their own vice principal.

Through this small school model, students can choose to specialize in curriculum that interests them and relates to their future academic and career goals. Teachers and administrators are able to get better acquainted students and their families, creating a more personalized educational experience with greater student accountability.

The Kearny campus has also felt “new” due to the opening of a new football stadium (with lights!), baseball field, and weight room in 2015. The gymnasium was also refurbished in 2017.

Interested in a tour? Contact school receptionist Maria Lopez at 858-496-8370 extension 2008 or [mlopez4@sandi.net](mailto:mlopez4@sandi.net).



Photo:

Student CJ Garzon assists Kearny Principal Ana Díaz-Booz with the ribbon cutting for Kearny’s Komet Stadium in 2015. Photo credit: Laura Farrar

.....

**FREE CAREER TRAINING**

**SAN DIEGO CONTINUING EDUCATION**
**sdce.edu**



## **Serra Mesa-Kearny Mesa Branch Library**

### **March/April, 2018 Events/Programs**

All San Diego Public Library Locations will be **Closed** Friday, March 30<sup>th</sup> and Saturday, March 31<sup>st</sup> in observance of Cesar Chavez Day.

**Art Exhibits** – The Friends of the Serra Mesa-Kearny Mesa Branch Library present the exhibit “Feather Rishi” by Lewis Grimes in the Community Room and Hopi Art and Kachina Dolls by Rachel Evans in the display cases.

### **Adult Programs**

**Japanese Brush Painting – Wednesdays, 1:15 p.m. – 3:45 p.m.** (except March 7 & 28) **and Thursdays, 12:30 p.m. – 3:00 p.m.** (Except March 29). Learn how to create beautiful tones of Japanese sumi-ink and paint with unique Japanese brush style. Geared towards 55+, but everyone 18+ is welcomed. “Walk-in registration in the class”. <https://cestudent.sdccd.edu/cereg/>

**AARP Tax Preparation Assistance – Fridays, February 2 thru April 13, 9:30 a.m. – 3:30 p.m. BY APPOINTMENT ONLY.** The AARP will be providing free tax help for taxpayers with low to moderate income on Fridays, February 2 - April 13. Please call/visit the library to make an appointment.

**Knitting Circle – Saturdays, 9:30 a.m.** (except March 31) Join the knitting circle. Improve your skills in this traditional art form.

**Tech Clinic – Saturdays and Sundays, 2:00 p.m.** (except March 31) Need help understanding how to use your tablet or mobile phone? Bring in your device for hands-on, one-on-one help to answer general questions about your device. Learn how to access SDPL’s digital content and other eResources.

**March 13, 5:00 p.m. Friends of the Library Meeting.** Join members of your community to discuss ways to support the library.

**March 13, 6:45 p.m. Serra Mesa Library Book Club.** Join members of your community to discuss *The Son* by Philipp Meyer.

**March 15, 3:30 p.m. Serra Mesa Village Meeting.** Join members of your community for presentations on healthy lifestyles for older adults.

**March 15, 7:00 p.m. Serra Mesa Planning Group.** A community meeting for an organization that advises the city on land use issues.

**March 21, 11:30 a.m. Kearny Mesa Planning Group.** A community meeting for an organization that advises the city on land use issues.

**March 26, 1:30 p.m. OASIS Monday at the Library: Brain Fit Now.** Join this evidence-based workshop to boost your brain health and lower your risk for Alzheimer’s disease and dementia. Learn about Brain Fit Now! A method that includes brain training, memory strategies, nutrition advice, physical activity, social connection tips, and stress management.

**March 25, 1:30 p.m. San Diego Folk Song Society.** Join the folk song circle and enjoy free, live music.

**March 28, 6:30 p.m. Serra Mesa Community Council.** A meeting to provide information and act as a forum for identifying and solving community problems.

**April 10, 6:30 p.m. One Book One San Diego, Special Book Discussion.** This event joins up with the Serra

Continued from page 9

Mesa Library Book Club and Stonecrest Book Club for a “Sips, Sweets & Spirited Discussion.” Come and discuss *The Sandcastle Girls* by Chris Bohjalian with other members of the community. Light refreshments of Armenian snacks will be provided. Please ask library staff for a copy of the book. Everyone 18+ is welcomed.

**April 18, 11:30 a.m. Kearny Mesa Planning Group.** A community meeting for an organization that advises the city on land use issues.

**April 19, 3:30 p.m. Serra Mesa Village Meeting.** Join members of your community for presentations on healthy lifestyles for older adults.

**April 19, 7:00 p.m. Serra Mesa Planning Group.** A community meeting for an organization that advises the city on land use issues.

**April 22, 1:30 p.m. San Diego Folk Song Society.** Join the folk song circle and enjoy free, live music.

**April 23, 1:30 p.m. OASIS Monday at the Library: How to Give a TED Talk.** Do you have what it takes to give a TED or TED-style talk? Join Marilyn McPhie for an informative presentation on how to get invited to speak at a TED event, what to talk about, how to prepare a talk, how to deliver your talk and how to make the most of the experience. See what is involved in “ideas worth spreading.”

**April 25, 6:30 p.m. Serra Mesa Community Council.** A meeting to provide information and act as a forum for identifying and solving community problems.

### **Children Programs**

**Do Your Homework @ the Library Homework Help -Mondays and Thursdays 3:00 p.m. - 6:00 p.m., Tuesdays and Wednesdays 3:00 p.m. - 7:00 p.m.** Students in Kindergarten through 8th grade can come in for free homework assistance! Bring in your homework to get assistance from one of our Homework Coaches!

**Kids Night with Hopscotch Tiny Tots – Tuesdays, 4:30 p.m.** Join Miss Kim for music, stories, arts and crafts in a program which is ideal for toddlers and preschoolers.

**Friday Morning Storytime – Fridays, 10:00 a.m. through April 13 (except March 30).** Join Ms. Carrie and Ms. Sandy every Friday morning for stories, songs, and fun!

**March 3, 1:00 p.m. Kelp Forest Ecosystems.** Students learn about the incredible algae in our ecosystem, including an interactive “creature features” lesson highlighting invertebrates, fish and sharks. In addition to this practical marine biology lesson, students will create an art project using watercolor pencils. Program is for students 6th-8th grade. Space is limited. **Registration required.** [SanDiego.gov/LibraryNext](http://SanDiego.gov/LibraryNext)

**March 5 & 19, 10:30 a.m. Monday Morning Storytime** Join Ms. Carrie for stories, songs, and fun!

**March 5, 4:00 p.m. Dr. Seuss Celebration.** Come celebrate Dr. Seuss’ Birthday with a Dr. Seuss animated short film and a Dr. Seuss craft.

**March 7 & 21, 4:00 p.m. LEGO Builder Club.** Join us to build Lego creations that will be displayed in the library.

**March 10, 1:00 p.m. Kitchen Chemistry: Glorious Chocolate.** The many wonders of chocolate, from the biochemical effects on humans to how and why it changes state are probed. We look at the history of the cocoa tree, including how it is processed and which chemicals contribute to the unique chocolate taste. Budding bakers will run an edible experiment and make chocolate cookies. Program is for students 6th-8th grade. Space is limited. **Registration required.** [SanDiego.gov/LibraryNext](http://SanDiego.gov/LibraryNext)

Continued from page 10

**March 12 & 26, 10:30 a.m. Preschool Craft.** Join us for a fun, easy-to-make children's craft.

**March 14 & 28, 12:00 p.m. Baby/Toddler Explore Time.** Come let your baby or toddler learn about the world by exploring. Little ones are able to make noise, play, and meet new friends. This is a loosely structured, baby-led program of play, music, art, stories, songs and more. For babies and toddlers 0-2 years.

**March 15, 22, & 29, 10:00 a.m. Music Time for Kids with Cowboy Bob.** Come dance with Cowboy Bob as he introduces music and instruments in a show appropriate for all ages.

**March 24, 1:00 p.m. Wearable Electronics.** Students will learn the basics of series circuits and build a set of flashlight gloves to take home. Program is for students 6th-8th grade. Space is limited. **Registration required.** [SanDiego.gov/LibraryNext](http://SanDiego.gov/LibraryNext)

**April 2, 9, 16, 23 & 30, 10:30 a.m. Monday Morning Storytime** Join Ms. Carrie every Monday morning for stories, songs, and fun!

**April 4 & 18, 4:00 p.m. LEGO Builder Club.** Join us to build Lego creations that will be displayed in the library.

**April 7, 1:00 p.m. Messy Science.** Join us for hands-on learning activities, including the opportunity to design structures and test their resiliency. Students explore concepts such as tsunamis, landslides, permafrost, glaciers, and sea level rise. Learn why and how things ooze, what makes an explosion and the hidden reason why some things can spin and others cannot. Come prepared to make a mess. Program is for students 6th-8th grade. Space is limited. **Registration required.** [SanDiego.gov/LibraryNext](http://SanDiego.gov/LibraryNext)

**April 11, 6:00 p.m. Spring Into STEAM: Build a Mars Colony.** NASA plans to send astronauts to Mars in 2030s. In this program, students will investigate if humans can live on the red planet and what they would need to survive. Using recycled materials students will design and build a Mars colony. This program is geared toward kids ages 9-12. Space is limited. Register at [www.SanDiego.gov/STEAM](http://www.SanDiego.gov/STEAM).

**April 12, 19, & 26, 10:00 a.m. Music Time for Kids with Cowboy Bob.** Come dance with Cowboy Bob as he introduces music and instruments in a show appropriate for all ages.

**April 20 & 27, 10:00 a.m. Baby/Toddler Explore Time.** Come let your baby or toddler learn about the world by exploring. Little ones are able to make noise, play, and meet new friends. This is a loosely structured, baby-led program of play, songs and more. For babies and toddlers 0-2 years.

**April 21, 1:00 p.m. Mysteries of the Human Genome.** During this class, students will explore the mysteries of the human genome. Learn about what makes each person unique and what people have in common. Program is for students 6th-8th grade. Space is limited. **Registration required.** [SanDiego.gov/LibraryNext](http://SanDiego.gov/LibraryNext)

**Apply for a Free Computer!! Computers 2 SD Kids at the Serra Mesa-Kearny Mesa Library – Classes on March 24 and April 28**

The San Diego Public Library and Computers 2 SD Kids are teaming up to provide computers for families with children. Volunteers will guide you through an introductory computer class at the library. Attendance at this class is required before you can receive a computer. Computers 2 SD Kids will give you a Technology Assistance Program application. They will review it and notify you whether you qualify based on your verified income. Sign-up at the Serra Mesa-Kearny Mesa Branch Library or call 858-573-1396 starting on the 1<sup>st</sup> of each month.

## **SERRA MESA PLANNING GROUP ELECTIONS TO BE HELD ON MARCH 15**

The Serra Mesa Planning Group will hold annual elections at its next meeting on Thursday, March 15<sup>th</sup> at the Serra Mesa/Kearney Mesa Library. The election will be held at 6:45 pm. The Serra Mesa Planning Group meeting will begin immediately following the voting or 7:15 pm-whichever is later. Election results will be announced during the meeting.

To be eligible to be elected to the Serra Mesa Planning Group (SMPG), you need to live in the community AND/OR own a business in the community AND/OR own land in the community. You also need to have attended at least two out of the last three meetings.

Community Planning Groups provide official recommendations to the City of San Diego on community goals and land development proposals.

Members serve a two-year term with half of the 15-member board being open for election every other year.

If you've been to a Serra Mesa Planning Group meeting, you're probably noticed placards that contain the name of the member and the name of an elementary school. Although that member probably did not attend that school, the goal of the Serra Mesa Planning Group is to get representation from different parts of the community and, because Serra Mesa is generally a residential community with six elementary schools in the San Diego School District, it seemed to make sense to have at least two members from the area covered by each of the six schools.

Because of this it is actually possible to get fewer votes than another candidate and still get elected. Here's how that works. Let's say you live in (or own land in or own a business in) the Cubberley area. Let's also say there are two people running for one open seat in the Cubberley area. You get 10 votes but the other person-that does not live in (or own land in or own a business in) the Cubberley area- gets 11 votes. Because you are live in (or own land in or own a business in) the Cubberley area and the other candidate does not, you would win the seat-even though you got fewer votes.

But, remember, the goal is to get two members representing each of the six elementary schools-for a

## **Don't Miss our Spring Event! Serra Mesa Egg Scramble!!**

**Serra Mesa's Spring Egg Scramble is back!**

Be the first to reach the golden egg and win a basket from the Spring Bunny! Each age group will have two golden eggs to find.

The event begins at 10:00 am with face painting, crafts, a bounce house, and tons of summer activities as we gear up for the main event. Top off your visit with a picture taken with the Spring Bunny!

**The Egg Scramble will begin promptly at 11:00am!**

Date: Saturday, April 24, 2018

Time: 10:00 a.m. to 11:30 a.m.

Location: Wegeforth Joint Use Field, adjacent to Serra Mesa Rec



total of 12 members-but there are 15 members. That means there would be at least three "open" seats. So, in the earlier example, the candidate that did not win the seat for the school could still win an "open" seat by getting the most votes of those that did not get a "school" seat.

Finally, if there aren't any candidates for an open seat in an elementary school area, that seat would become an "open" seat and could be won by anyone meeting the requirements to be a Serra Mesa Planning Group member.

Note to Tom: Thanks for explaining this to me before I became a member!

Any questions or interested in being a candidate? Ask it by sending an email to [SMPG@SerraMesa.org](mailto:SMPG@SerraMesa.org)

***Serra Mesa Community Council Welcomes  
January / February New and Renewed Subscribers***

|                            |                                |                             |
|----------------------------|--------------------------------|-----------------------------|
| Mary Lou Allgire           | Arno & Else Kikillus           | E. Proctor & J. Vigil       |
| Kathleen Andrews *         | Christopher & Beverly Latham * | Charles West *              |
| Carolyn Barr *             | Michael & Susan Lauer *        | Ruth Whitehead              |
| Pat Baumgartner            | Dianne Laviolette *            | Les & Marilyn Williamson ** |
| Larry & Sharon Bay         | Larry & Billie Little          | Carol Windham               |
| Tamara Bentz               | Paul & Geraldine McClure       | N.R. Yocum                  |
| Jan Brooks                 | Brian & Dolores McPherson      |                             |
| Dorothy Burger *           | Gail Miller                    |                             |
| Ray & Evelyn Buttles *     | Wally & Dawn Moeller           |                             |
| John & Sherrie Caradonna   | Cindy & Paul Moore *           |                             |
| Michael & Terry Chism *    | Erika Moore                    |                             |
| Connie Chovan              | Wolfgang & Trudi Muilwijk      |                             |
| Jon & Melissa Cima         | Bonnie Myles                   |                             |
| Anne Clifford *            | Joe Neff & Linda King **       |                             |
| Mary DeBates               | Karen & Steve Niemela *        |                             |
| Vicki DeNardo              | John & Barbara Pephens         |                             |
| Gene & Dorothy Dusek       | Harlan & Mary Ann Price        |                             |
| Ron & Gail Ewert **        | Edward & Jacqueline Renger     |                             |
| Kira Finkenberg *          | Susan Rooney                   |                             |
| Janice Fletcher            | Maria Seabourne                |                             |
| Jack & Asako Goddard       | Duane Shockey                  |                             |
| Richard & Doreen Gorostiza | Michael & Kathleen Stark       |                             |
| Richard Jeffries           | Larry & Kathy Sterling         |                             |
| David & Helen Johnston     | Mike Sumber                    |                             |
| Gary Keller                | Justin & Sara Turner           |                             |

Donation: \*\*Benefactor    \*Sponsor

**Observer Renewal**

When it is time to renew your Observer, the renewal date is highlighted and stamped, "to be renewed." Also, a postcard will be mailed and, if possible, a phone call is made to remind you. It is greatly appreciated if you pay as soon as you notice it's time to renew.

Maybe you have a special neighbor that you'd like to say "thank you" to, or maybe you have a new neighbor that you'd like to say "welcome." We highly recommend giving a subscription to the Observer (six editions/year). A post card will be sent to the recipient.

Please fill out the enclosed form and send it with your check to P.O. Box 23315,  
San Diego, CA. 92193.



## **Franklin Ridge Road Update**

An environmental lawsuit was filed on November 27 on behalf of the “Save Civita Because Sudberry Won’t” group. The group is suing to protect public safety and the quality of life in Civita and Serra Mesa. There are Serra Mesa residents on this group’s board, who will represent Serra Mesa’s interests. An environmental lawsuit can take a year or longer before being heard by a judge, who makes the final legal decision.

For more information about the Serra Mesa perspective, go to <http://www.serramesa.org/hot-topics/>; Civita perspective, <http://www.savecivita.com/>.

Additional funds are needed for the lawsuit. If you are interested in contributing, go to <http://www.savecivita.com/action-1.html>.

.....

## **SERRA MESA VILLAGE NEWS**



A Christmas outing to the Del; plant your own succulent garden; Ceramics class; These are recent activities of Serra Mesa Village, A Neighborly Network of Seniors for Seniors. Monthly Connection Meetings, held the third Thursday of every month at Serra Mesa Library have included presentations from Hearing Loss Assoc. & Heart & Stroke Prevention. Upcoming outings, first Thursday of every month, include Living Coast Discovery Center, a day in Julian and Japanese Friendship Garden in April (to enjoy the Cherry Blossoms). Although Serra Mesa Village meetings are geared to seniors, all are welcome, especially those who would volunteer to help seniors in need. March and April calendars for the Village are included in this issue including times and where to meet. Please join us. Call 858-565-2473 – leave your name, phone number/email and a Board Member will contact you to answer your questions.



## Serra Mesa Housing History: Rancho Cabrillo Neighborhood

Gwen Sanchez via Suzanne Wells shared with us the original sales brochure for her home located in Rancho Cabrillo, an area of Serra Mesa, located south of Gowdy, north of Raejean, east of Greyling, and west of Chaucey. Here's the brochure information:

**"GREAT AMERICA HOMES!"**

*California Contemporary Series*

IN BEAUTIFUL RANCHO CABRILLO

LUXURY HOMES DESIGNED FOR THE ENJOYMENT OF  
THE AMERICAN WAY OF LIFE AT ITS VERY BEST

GREAT AMERICA HOMES are nationally famous for design, craftsmanship and value. The new "California Contemporary Series" designs are even finer in every way than any of the wonderful Great American Homes of past years, with improvements and refinements in nearly every detail.

They are designed by a noted team of experts from basic surveys of the desires and needs of the modern American family. After 34 years of experience in building fine homes, Tri-W Builders has learned that you don't want a fad or a passing fancy, but a home that will never go out of style, that will always keep its prestige and value. Great America Homes are good, sound, conventional homes with maximum investment security for the years to come.

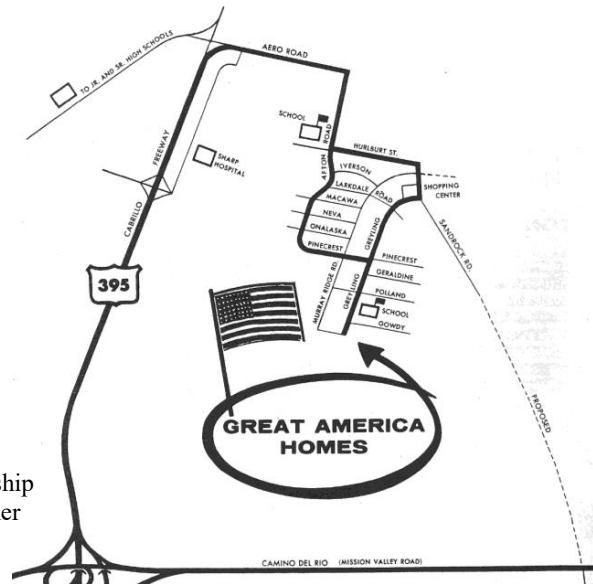

### FEATURE CHECK LIST

#### LOCATION

10 minutes from downtown, 5 minutes from Convair  
Astronautics  
Bus Service  
Elementary school on site  
Jr.-Sr. High nearby  
Shopping Center in and expanding  
View lots up to one acre  
Utilities, streets, walks, curbs in and paid for  
Landscaping, lawn, trees and shrubs front sides and rear

#### CONSTRUCTION & INTERIORS

Up to 1400 sq ft. inside living area  
1 x 6 solid sub-floors laid diagonally  
Select oak hardwood floors over insulation  
Painted walls and ceilings  
Bourne aluminum windows and screens  
Solid core front door  
Buffet pass-thru  
Solid foundation walls  
Fireplaces with ash pits and clean-outs  
Barbecue flued to chimneys  
2 1/2 car garages with overhead doors  
Large concrete patios fully covered  
Glass lined hot water heaters with 10 year warranty  
Rough-in for water softener with every house  
Minneapolis-Honeywell round thermostats  
Electric heating lamps in baths  
Chimes by No-Tone  
Challenger locks

Sliding wardrobe doors  
100 amp service  
6-foot ceramic tile shower stalls  
5 feet of tile over tub  
Heavy rock roofs in color  
Lath and plaster  
Custom lighting fixtures  
Pullmans in bath-tile topped  
Double mirrors in baths  
Natural cedar kitchen cabinets  
Built in O'Keefe & Merritt ranges and ovens in color with glass door and timing controls  
8-foot aluminum sliding patio doors  
Ceramic tile kitchen counter tops  
All exterior doors fully weatherstripped  
Insulated with aluminum foil backed insulation  
Full 16 foot driveways  
Choice of two or three elevations with each model  
Maticco vinyl tile in kitchens and baths  
Waste King garbage disposals  
Colored plumbing fixtures throughout  
Nutone Coppertone hoods, fan and light over ranges  
Central forced air heat with summer switch and full insulation of ducts  
Hollywood rear doors-sliding vents  
Chrome plated fixtures  
Termite resistant sills  
Double sinks  
Grade marked lumber  
All floor plans expandable  
All Copper plumbing

Great America Homes  
Contemporary Models  
Rancho Cabrillo



*The Arlington*



Real beauty, comfort and plenty of living space at an economical price are the features of this always popular Great America Home. 3 bedrooms, 1 bath, 2 elevations.

PRICE 19,900  
DOWN PAYMENT \_\_\_\_\_  
MO. PAYMENTS \_\_\_\_\_



*The Gettysburg*

This long-time favorite now has more living space than ever. Comparable 3 bedroom, 2 bath homes in the typical subdivisions would sell for much more. 2 elevations.

PRICE 17,900  
DOWN PAYMENT \_\_\_\_\_  
MO. PAYMENTS \_\_\_\_\_

*The Emerson*

This big 3 bedroom, 2 bath home has a fireplace in the living room and a large barbecue in the big covered outdoor patio. It has always been the most popular Great America Home, and the new, improved model makes it a better value than ever. 3 elevations.

PRICE 19,900  
DOWN PAYMENT \_\_\_\_\_  
MO. PAYMENTS \_\_\_\_\_

428  
429  
433

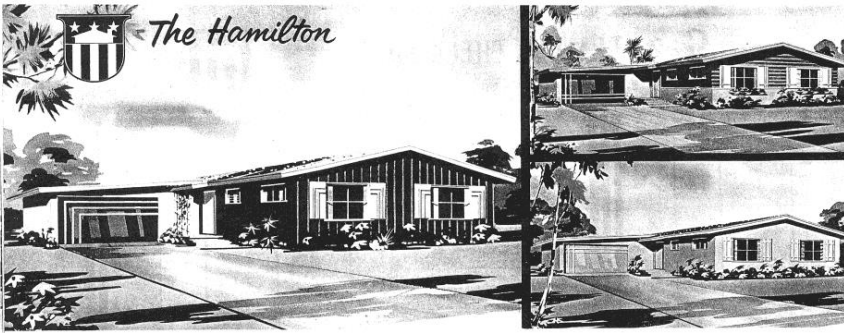

This home is a dream for the big, active family. It has 3 bedrooms, big family room, and 2 baths. Also a wonderful covered patio for real California outdoor living. 3 elevations.

PRICE 18,300  
DOWN PAYMENT \_\_\_\_\_  
MO. PAYMENTS \_\_\_\_\_

## Great America Homes Contemporary Models Rancho Cabrillo

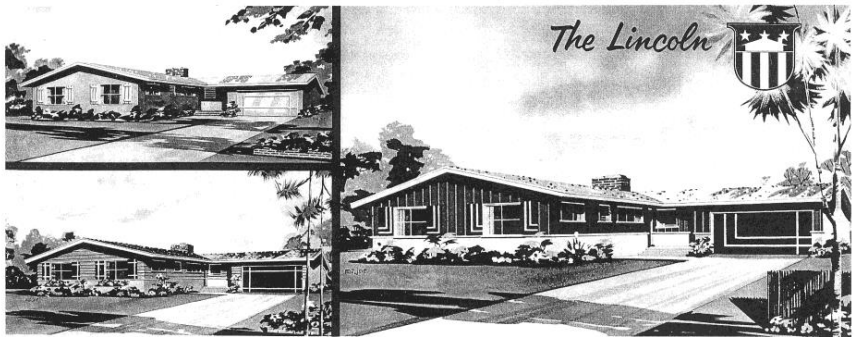

The luxurious Lincoln is a masterpiece of design and workmanship. It has 4 full bedrooms, 2 baths, a fireplace in the living room and a beautiful barbecue in the lovely outdoor covered patio. The Lincoln would sell for from \$5,000 to \$10,000 more in areas with inflated land values. 3 elevations.

PRICE 19,600  
DOWN PAYMENT \_\_\_\_\_  
MO. PAYMENTS \_\_\_\_\_



Here is a brand new Great America Home, being shown for the first time in the California Contemporary Series. 3 big bedrooms, 2 baths and patio. 2 beautiful elevations.

PRICE \_\_\_\_\_  
DOWN PAYMENT \_\_\_\_\_  
MO. PAYMENTS \_\_\_\_\_



# The City of SAN DIEGO

## Serra Mesa Recreation Center

9020 Village Glen Dr.  
San Diego, CA 92123  
(858) 573-1408



When: Saturday March 24, 2018

- Crafts, astro jump, and activities from 10:00-11:00 am
- Egg Hunt starts at 11:00 am

Where: Wegeforth Joint Use Field-Adjacent to  
Mesa Recreation Center

Serra

### Age Groups

Egg Scramble starts promptly at 11:00 am!  
Please try to arrive by 10:45 am

Group 1: 1-3 years

Group 2: 4-6 years

Group 3: 7-9 years

Group 4: 10-12 years

Don't forget to  
bring a basket!



Plus a special visit from the  
Spring  
Bunny!



\*\*\*EGG HUNT AND ACTIVITIES ARE FREE\*\*\*

AS A RECIPIENT OF FEDERAL FUNDS, THE CITY OF SAN DIEGO CANNOT DISCRIMINATE AGAINST ANYONE ON THE BASIS OF RACE, COLOR, GENDER, RELIGIOUS CREED, MARITAL STATUS, SEXUAL ORIENTATION, ANCESTRY, NATIONAL ORIGIN, AGE, MENTAL OR PHYSICAL DISABILITY, MEDICAL CONDITION INCLUDING HIV, AIDS & AIDS RELATED COMPLEX. IF ANYONE BELIEVES HE OR SHE HAS BEEN DISCRIMINATED AGAINST, HE OR SHE MAY FILE A COMPLAINT ALLEGING THE DISCRIMINATION WITH EITHER THE CITY OF SAN DIEGO PARK & RECREATION DEPARTMENT. CONTACT THE DISTRICT MANAGER AT (619) 221-8804 OR THE OFFICE OF EQUAL OPPORTUNITY, US DEPARTMENT OF THE INTERIOR, WASHINGTON D.C. 20240. THIS INFORMATION IS AVAILABLE IN ALTERNATE FORMATS UPON REQUEST.



## SMCC Subscription Application or Renewal Form & Interest/Volunteer Survey

If you are interested in being contacted about any of the organizations listed below and/or you wish to receive a bi-monthly newsletter **or renew** your subscription, please fill out the following information. Return this form to the Serra Mesa Community Council, PO Box 23315, San Diego, CA 92193.

Last Name \_\_\_\_\_ First \_\_\_\_\_ E-mail \_\_\_\_\_  
 Address \_\_\_\_\_ City \_\_\_\_\_ State \_\_\_\_\_ Zip Code \_\_\_\_\_  
 Home Phone \_\_\_\_\_ Work Phone \_\_\_\_\_ Occupation \_\_\_\_\_

**Subscription Form** - Enclosed is my check payable to the Serra Mesa Community Council to subscribe at the following level:

Household (\$15) \_\_\_\_ Sponsor (\$25) \_\_\_\_ Benefactor (\$50) \_\_\_\_

**How did you hear about us?** \_\_\_\_\_

| Need More Information    | Want to Volunteer        | Brief Description of Serra Mesa Organizations                                                                                                                                                              |
|--------------------------|--------------------------|------------------------------------------------------------------------------------------------------------------------------------------------------------------------------------------------------------|
| <input type="checkbox"/> | <input type="checkbox"/> | <b>Community Council.</b> Sponsors clean-ups, publishes newsletter, liaison between elected officials & the community, meets 10 times/yr. Volunteers needed: Board & special projects. Commitment: varies. |
| <input type="checkbox"/> | <input type="checkbox"/> | <b>Planning Group.</b> Advises the City on the Serra Mesa Community Plan and land use issues. Volunteers needed. Trained & indemnified by the City. Commitment: 3.5 hours/month.                           |
| <input type="checkbox"/> | <input type="checkbox"/> | <b>Recreation Council.</b> Plans, promote, publicizes & helps provide recreation opportunities for citizens in Serra Mesa. Volunteers needed: Council. No training needed. Commitment: 1.5 hour/month      |
| <input type="checkbox"/> | <input type="checkbox"/> | <b>Enhancement Committee.</b> Sends educational letters to residents requesting code compliance. Promotes community improvement. Trained & indemnified by the City. Commitment: 3 hours/month.             |
| <input type="checkbox"/> | <input type="checkbox"/> | <b>Friends of the Library.</b> Provides summer reading program, extra books & tapes, & sponsors special library events for the Serra Mesa Library. Volunteers needed: Board. Commitment: 5 hours/month.    |
| <input type="checkbox"/> | <input type="checkbox"/> | <b>Friends of Ruffin Canyon.</b> Friends of Ruffin Canyon removes invasive non native plants from the canyon and replaces them with natives.                                                               |
| <input type="checkbox"/> | <input type="checkbox"/> | <b>Serra Mesa Food Pantry.</b> Staff the Food Pantry, pick up donated food, coordinate food drives, organize community sponsors. Commitment: varies.                                                       |
| <input type="checkbox"/> | <input type="checkbox"/> | <b>Serra Mesa Village.</b> An active non-profit organization for residents 55+ who promote connections to help our members thrive.                                                                         |

To volunteer for one of the groups listed below call 858-565-2473.

**Churches.** Volunteer needs, training, & commitment varies with each church.

**Education & PTAs.** Volunteers needed: school based parent groups, readers/listeners in the schools, & various projects at schools. Training & commitment varies with activity.

**Sports** (Soccer, Baseball, Basketball). Volunteers needed: referees, managers, coaches, scorekeepers, etc. Training & commitment varies with activity.

**Youth Activities** (Girls Scouts, Boy Scouts, etc.). Volunteers needed: leaders, sponsors, & volunteers for special activities. Training provided. Commitment varies.

**Views concerning the present and future Serra Mesa.** Please attach a sheet with issues, suggested goals, and suggestions.

**Skills/Experience/Interests.** Sometimes an organization needs specialized help. If you wish to volunteer, then please attach a sheet with a list of your skills/experiences.

***Serra Mesa Observer***  
Editor: *Ronda Adams*  
Post Office Box 23315  
San Diego, CA 92193

PRSRT STD  
US POSTAGE  
PAID  
PERMIT 0639  
SAN DIEGO CA

# Dated Material

---

## FRIENDSHIP LUNCH OPEN TO THE COMMUNITY

Join us for the Friendship Lunch  
Volunteers from our neighborhood offer  
the Serra Mesa community  
a soup, bread, and dessert every Wednesday noon to 1:00 p.m.

The "Friendship Lunch" has **no age limitation**

There is no cost but all are invited to bring non-perishable cans or  
packages of food for the Serra Mesa Food Pantry

Located at Mission Village Christian Fellowship 2650 Melbourne Drive 92123  
More information at 858-277-6572 or 858-278-2633

| Sun                                                                                                                                                                          | Mon                                                                   | Tue                                                                                          | Wed                                                                                                                            | Thu                                                                                             | Fri                                                                 | Sat                           |
|------------------------------------------------------------------------------------------------------------------------------------------------------------------------------|-----------------------------------------------------------------------|----------------------------------------------------------------------------------------------|--------------------------------------------------------------------------------------------------------------------------------|-------------------------------------------------------------------------------------------------|---------------------------------------------------------------------|-------------------------------|
| <b>SMRC Serra Mesa Rec 9020 Village Dr.</b><br><b>MVCF Mission Village Christian Fellowship</b><br><b>2650 Melbourne Dr.</b><br><b>SM/KM Library</b><br><b>9005 Aero Dr.</b> |                                                                       |                                                                                              |                                                                                                                                | <b>1</b><br>8:30-10:00 AM FEELING FIT CLUB - SMRC<br><br><b>10:00 AM - SMV DAY TRIP - SM/KM</b> | <b>2</b><br>9 AM - WALKING GROUP - SMRC                             | <b>3</b><br>PEACH BLOSSOM DAY |
| <b>4</b><br>HUG A GI DAY                                                                                                                                                     | <b>5</b><br>9 AM - WALKING GROUP - SMRC<br>1:00 PM - Board Mtg SMRC   | <b>6</b><br>8:30-10:00 AM FEELING FIT CLUB - SMRC<br>2:00-4:00 PM CERAMICS CLASS - SMRC      | <b>7</b><br>9 AM - WALKING GROUP - SMRC<br>10:30 AM-EXERCISE MVCF<br>12:00 - FRIENDSHIP LUNCH - MVCF                           | <b>8</b><br>8:30-10:00 AM FEELING FIT CLUB - SMRC                                               | <b>9</b><br>9 AM - WALKING GROUP - SMRC                             | <b>10</b>                     |
| <b>11</b>                                                                                                                                                                    | <b>12</b><br>9 AM - WALKING GROUP - SMRC<br><br>PLANT A FLOWER DAY    | <b>13</b><br>8:30-10:00 AM FEELING FIT CLUB - SMRC                                           | <b>14</b><br>9 AM - WALKING GROUP - SMRC<br>10:30 AM-EXERCISE MVCF<br>12:00 - FRIENDSHIP LUNCH - MVCF<br>1:30 PM- MOVIE - SMRC | <b>15</b><br>8:30-10:00 AM FEELING FIT CLUB - SMRC<br><br><b>3:30-5:30 PM - SMV CONNECTION</b>  | <b>16</b><br>9 AM - WALKING GROUP - SMRC                            | <b>17</b><br>ST PATRICK'S DAY |
| <b>18</b>                                                                                                                                                                    | <b>19</b><br>9 AM - WALKING GROUP - SMRC                              | <b>20</b><br>8:30-10:00 AM FEELING FIT CLUB - SMRC<br><br>2:00-4:00 PM CERAMICS CLASS - SMRC | <b>21</b><br>9 AM - WALKING GROUP - SMRC<br>10:30 AM-EXERCISE MVCF<br>12:00 - FRIENDSHIP LUNCH - MVCF                          | <b>22</b><br>8:30-10:00 AM FEELING FIT CLUB - SMRC<br><br>NAT'L GOOF OFF DAY                    | <b>23</b><br>9 AM - WALKING GROUP - SMRC                            | <b>24</b>                     |
| <b>25</b><br>WAFFLE DAY                                                                                                                                                      | <b>26</b><br>9 AM - WALKING GROUP - SMRC<br><br>1:30 PM - OASIS SM/KM | <b>27</b><br>8:30-10:00 AM FEELING FIT CLUB - SMRC                                           | <b>28</b><br>9 AM - WALKING GROUP - SMRC<br>10:30 AM-EXERCISE MVCF<br>12:00 FRIENDSHIP LUNCH - MVCF<br>1:30 PM - MOVIE SMRC    | <b>29</b><br>8:30-10:00 AM FEELING FIT CLUB - SMRC                                              | <b>30</b><br>9 AM - WALKING GROUP - SMRC<br><br>I AM IN CONTROL DAY | <b>31</b>                     |

# April 2018

May ▶

| Sun                          | Mon                                                                         | Tue                                                                                                                                                                       | Wed                                                                                                                               | Thu                                                                                                  | Fri                                                       | Sat                                 |
|------------------------------|-----------------------------------------------------------------------------|---------------------------------------------------------------------------------------------------------------------------------------------------------------------------|-----------------------------------------------------------------------------------------------------------------------------------|------------------------------------------------------------------------------------------------------|-----------------------------------------------------------|-------------------------------------|
| <b>1</b><br>APRIL'S FOOL DAY | <b>2</b><br>9:00 AM walking group - SMRC<br><b>1:00 PM - Board Mtg SMRC</b> | <b>3</b><br>8:30-10:00 AM - Feeling Fit Club SMRC<br>2:00-4:00 PM - CERAMICS CLASS - SMRC<br>WORLD PARTY DAY                                                              | <b>4</b><br>9:00 AM walking group - SMRC<br>10:30 AM - Exercise - MVCF<br>12:00 - Friendship Lunch - MVCF                         | <b>5</b><br>8:30-10:00 AM - Feeling Fit Club SMRC<br><br><b>10:00 AM - SMV Day Trip - SM/KM</b>      | <b>6</b><br>9:00 AM walking group- SMRC                   | <b>7</b><br>NO HOUSEWORK DAY        |
| <b>8</b>                     | <b>9</b><br>9:00 AM walking group - SMRC                                    | <b>10</b><br>8:30-10:00 AM - Feeling Fit Club SMRC                                                                                                                        | <b>11</b><br>9:00 AM walking group - SMRC<br>10:30 AM - Exercise - MVCF<br>12:00 - Friendship Lunch - MVCF<br>1:30 - Movie - SMRC | <b>12</b><br>8:30-10:00 AM - Feeling Fit Club SMRC<br><br>GRILLED CHEESE DAY                         | <b>13</b><br>9:00 AM walking group SMRC                   | <b>14</b><br>LOOK UP AT THE SKY DAY |
| <b>15</b><br>THAT SUCKS DAY  | <b>16</b><br>9:00 AM walking group - SMRC                                   | <b>17</b><br>8:30-10:00 AM - Feeling Fit Club SMRC<br>2:00-4:00 PM - CERAMICS CLASS - SMRC                                                                                | <b>18</b><br>9:00 AM walking group - SMRC<br>10:30 AM - Exercise - MVCF<br>12:00 - Friendship Lunch - MVCF                        | <b>19</b><br>8:30-10:00 AM - Feeling Fit Club SMRC<br><br><b>3:30-5:30 PM - SMV Connection/SM/KM</b> | <b>20</b><br>9:00 AM walking group SMRC                   | <b>21</b>                           |
| <b>22</b><br>EARTH DAY       | <b>23</b><br>9:00 AM walking group - SMRC<br>1:30 PM -OASIS SM/KM           | <b>24</b><br>8:30-10:00 AM - Feeling Fit Club SMRC                                                                                                                        | <b>25</b><br>9:00 AM walking group - SMRC<br>10:30 AM - Exercise - MVCF<br>12:00 - Friendship Lunch - MVCF<br>1:30 - Movie - SMRC | <b>26</b><br>8:30-10:00 AM - Feeling Fit Club SMRC                                                   | <b>27</b><br>9:00 AM walking group- SMRC<br><br>ARBOR DAY | <b>28</b><br>KISS YOUR MATE DAY     |
| <b>29</b>                    | <b>30</b><br>9:00 AM walking group - SMRC                                   | <b>SMRC-Serra Mesa Rec Ctr - 9020 Village Glen Dr.</b><br><b>MVCF-Mission Village Christian Fellowship - 2650 Melbourne Dr.</b><br><b>SM/KM Library - 9005 Aero Drive</b> |                                                                                                                                   |                                                                                                      |                                                           |                                     |