

GENERAL NOTES

1. IT SHALL BE THE RESPONSIBILITY OF THE CONTRACTOR TO VERIFY ALL EXISTING CONDITIONS AND RIGHT OF WAY PRIOR TO CONSTRUCTION.
2. ALL WORK SHALL CONFORM TO THE MOST RECENT ADOPTED EDITION OF THE FOLLOWING MANUALS:
- | DOCUMENT NO. | EDITION | DESCRIPTION |
|---------------|-------------|---|
| PWPI070116-01 | 2018 | STANDARD SPECIFICATIONS FOR PUBLIC WORKS CONSTRUCTION (THE "GREENBOOK") |
| PWPI070116-02 | 2018 | CITY OF SAN DIEGO STANDARD SPECIFICATIONS FOR PUBLIC WORKS CONSTRUCTION (THE "WHITEBOOK") |
| PWPI070116-03 | 2018 | CITY OF SAN DIEGO STANDARD DRAWINGS FOR PUBLIC WORKS CONSTRUCTION |
| PWPI092816-05 | 2018 | CALIFORNIA DEPARTMENT OF TRANSPORTATION (CALTRANS) STANDARD SPECIFICATIONS |
| PWPI092816-06 | 2018 | CALTRANS STANDARDS PLANS |
| PWPI092816-10 | 2014 REV. 6 | CALIFORNIA MANUAL ON UNIFORM TRAFFIC CONTROL DEVICES (CAMUTCD) |
3. ALL SIGNING AND STRIPING IS SUBJECT TO THE APPROVAL OF THE CITY ENGINEER PRIOR TO INSTALLATION AND/OR REMOVAL.
4. THE CONTRACTOR SHALL REMOVE ALL EXISTING STRIPING, PAVEMENT MARKINGS AND LEGENDS BY HYDROBLASTING. ANY DEBRIS SHALL BE PROMPTLY REMOVED BY THE CONTRACTOR.
5. PEDESTRIAN CROSSWALKS, LIMIT LINES, PAVEMENT ARROWS, PAVEMENT LEGENDS, DIAGONAL MARKINGS, CHEVRON MARKINGS AND ALL BIKEWAY MARKINGS SHALL BE INSTALLED UTILIZING 125 MIL THICKNESS THERMOPLASTIC MARKING MATERIAL.
6. CONTINENTAL CROSSWALK MARKINGS SHALL HAVE INSIDE DIMENSIONS OF 10 FEET, UNLESS INDICATED OTHERWISE.
7. ALL MEDIAN ROSES SHALL BE PAINTED YELLOW AS DIRECTED.
8. A MINIMUM OF 2 INCH BLACK BORDER SHALL BE APPLIED TO ALL TRAFFIC STRIPING MARKINGS AND LEGENDS ON CONCRETE PAVEMENT.
9. THE CONTRACTOR SHALL NOTIFY THE CITY TRAFFIC ENGINEER AT (619) 495 4742 A MINIMUM OF FIVE (5) WORKING DAYS PRIOR TO AND UPON COMPLETION OF STRIPING AND SIGNING.
10. ORTHOGRAPHIC PHOTOS SHOWN IN THE BACKGROUND ARE FOR REFERENCE ONLY AND MAY NOT REFLECT EXISTING CONDITIONS.
11. ALL SIGNS SHOWN ON THE STRIPING PLANS SHALL BE NEW SIGNS PROVIDED BY THE CONTRACTOR OR CITY OF SAN DIEGO STREET DIVISION, AS INDICATED ON THE PLANS, EXCEPT FOR THE EXISTING SIGNS SPECIFICALLY INDICATED TO BE RELOCATED OR TO REMAIN.
12. SIGN POSTS SHALL BE INSTALLED WITH SQUARE PERFORATED STEEL TUBING WITH A BREAKAWAY BASE PER CITY OF SAN DIEGO STANDARD DRAWING M 45.
13. STATIONING PROVIDED FOR STRIPING LAYOUT ONLY AND IS NOT SURVEY BASED STATIONING.

MISSION VILLAGE DRIVE
STRIPING, SIGNING &
ELECTRICAL IMPROVEMENT

SHEET INDEX

SHEET NO.	DISCIPLINE CODE	TITLE	LIMITS
1	T-1	STRIPING, SIGNING & ELECTRICAL COVER SHEET	
2	T-2	DETAILS & LEGEND	
3	T-3	STRIPING REMOVAL PLAN	FRIARS ROAD (STA. 0+00) TO GRAMERCY DR (STA. 20+00)
4	T-4	STRIPING PLAN	FRIARS ROAD (STA. 00+00) TO GRAMERCY DR (STA. 20+00)
5	T-5	STRIPING PLAN	FRIARS ROAD (STA. 20+00) TO GRAMERCY DR (STA. 31+00)
6	T-6	STRIPING PLAN	FRIARS ROAD (STA. 32+00) TO GRAMERCY DR (STA. 42+00)
7	T-7	STRIPING PLAN	FRIARS ROAD (STA. 43+00) TO GRAMERCY DR (STA. 51+00)
8	T-8	STRIPING PLAN	FRIARS ROAD (STA. 52+00) TO GRAMERCY DR (STA. 61+00)
9	T-9	SIGN AND DATA TABLE	SIGN AND POST DATA TABLE
10	T-10	SIGNING PLAN	FRIARS ROAD (STA. 00+00) TO GRAMERCY DR (STA. 20+00)
11	T-11	SIGNING PLAN	FRIARS ROAD (STA. 20+00) TO GRAMERCY DR (STA. 31+00)
12	T-12	SIGNING PLAN	FRIARS ROAD (STA. 32+00) TO GRAMERCY DR (STA. 42+00)
13	T-13	SIGNING PLAN	FRIARS ROAD (STA. 43+00) TO GRAMERCY DR (STA. 51+00)
14	T-14	SIGNING PLAN	FRIARS ROAD (STA. 52+00) TO GRAMERCY DR (STA. 61+00)
15	E-1	ELECTRICAL PLAN	FRIARS ROAD (STA. 20+00) TO GRAMERCY DR (STA. 42+00)
16	E-2	ELECTRICAL PLAN	FRIARS ROAD (STA. 43+00) TO GRAMERCY DR (STA. 51+00)
17	E-3	ELECTRICAL PLAN	FRIARS ROAD (STA. 52+00) TO GRAMERCY DR (STA. 61+00)

STRIPING CONSTRUCTION NOTES (THIS SHEET)

1. INSTALL BIKE LANE ARROW AND BIKE SYMBOL WITH PERSON PER CALTRANS STANDARD PLAN A24A, AT 300' INTERVALS OR AS SHOWN PER PLAN. BIKE LANE ARROW OR BIKE LANE SYMBOL WITH PERSON SHOULD NOT BE PLACED IN CUTTER PAN WHERE PRESENT.
2. INSTALL 6" WHITE DIAGONAL CROSS HATCHING THERMOPLASTIC 125 MIL STRIPE, ANGLED AT 30 DEGREES AND AT 20' INTERVALS, SEE BUFFERED BICYCLE LANE DETAIL.
3. INSTALL WHITE CONTINENTAL CROSSWALK MARKINGS PER CITY OF SAN DIEGO STANDARD DRAWING NUMBER SDM 116. ALL TRAFFIC LINES AND MARKINGS SHOULD BE A MINIMUM OF 4' FROM CONTINENTAL CROSSWALK MARKINGS. RESIDENT ENGINEER TO APPROVE CROSSWALK MARKING LAYOUT IN FIELD PRIOR TO INSTALLATION. ONLY STRIPE CONTINENTAL CROSSWALKS WITHIN RESURFACING LIMITS.
- 3A. INSTALL YELLOW CONTINENTAL CROSSWALK MARKINGS PER CITY OF SAN DIEGO STANDARD DRAWING NUMBER SDM 116. ALL TRAFFIC LINES AND MARKINGS SHOULD BE A MINIMUM OF 4' FROM CONTINENTAL CROSSWALK MARKINGS. RESIDENT ENGINEER TO APPROVE CROSSWALK MARKING LAYOUT IN FIELD PRIOR TO INSTALLATION. ONLY STRIPE CONTINENTAL CROSSWALKS WITHIN RESURFACING LIMITS.

TRAFFIC DATA TABLE

STREET NAME	LIMITS	AVERAGE DAILY TRAFFIC VOLUME	POSTED SPEED LIMIT	PLANNED BIKEWAY CLASSIFICATION PER CP/BMP	STREET CLASSIFICATION	BIKEWAY MILEAGE
MISSION VILLAGE DR	GRAMERCY DR TO FERMI AVE	N/A	25 MPH (NB) 40 MPH (SB)	CLASS II OR III (BMP)	MAJOR	1.15 MILES (CLASS II) NB
MISSION VILLAGE DR	FERMI AVE TO SHAWN AVE	N/A	40 MPH	CLASS II OR III (BMP)	MAJOR	
MISSION VILLAGE DR	SHAWN AVE TO RONDA AVE	12,100 (2016)	40 MPH	CLASS II OR III (BMP)	MAJOR	.76 MILES (CLASS II) SB
MISSION VILLAGE DR	FRIARS ROAD TO RONDA AVE	13,960 (2016)	45 MPH	CLASS II OR III (BMP)	MAJOR	

SIGNING CONSTRUCTION NOTES

15. INSTALL NEW SIGN.

ELECTRICAL CONSTRUCTION NOTES

11. REPLACE EXISTING LOOPS WITH NEW TYPE E (MOD) DETECTOR LOOPS PER THE CITY OF SAN DIEGO STANDARD DRAWING SDE 104 AND NEW TYPE E DETECTOR LOOPS PER CALTRANS LOOP DETECTOR CONFIGURATION STANDARD PLAN ES 5B AS SHOWN ON PLAN.
12. INSTALL NEW TYPE E DETECTOR LOOPS PER CALTRANS LOOP DETECTOR CONFIGURATION STANDARD PLAN ES-5B 230' FROM LIMIT LINE FOR ADVANCED DETECTION AS SHOWN ON PLAN.
13. INSTALL TYPE Q BICYCLE DETECTOR LOOP AND DETECTOR LEAD-IN CABLE (DLC) FOR EVERY NEW BICYCLE LOOP DETECTOR TO THE CONTROLLER CABINET, PER CALTRANS STANDARD PLAN ES-5B, AT 44' IN ADVANCE OF LIMIT LINE, OR AS SHOWN PER PLAN. CONTRACTOR TO ENSURE ALL NECESSARY WORK IS COMPLETED TO MAKE NEW LOOP(S) OPERATIONAL.

STRIPING DETAILS

LANE WIDTH DIMENSIONS ARE DEFINED AS CENTER OF STRIPE TO FACE OF CURB/MEDIAN (WHERE PRESENT) OR CENTER OF STRIPE TO CENTER OF STRIPE UNLESS OTHERWISE NOTED. THE REFERENCE LINE OF THE SPECIFIC STRIPING DETAILS ARE SHOWN BELOW (NOT TO SCALE).

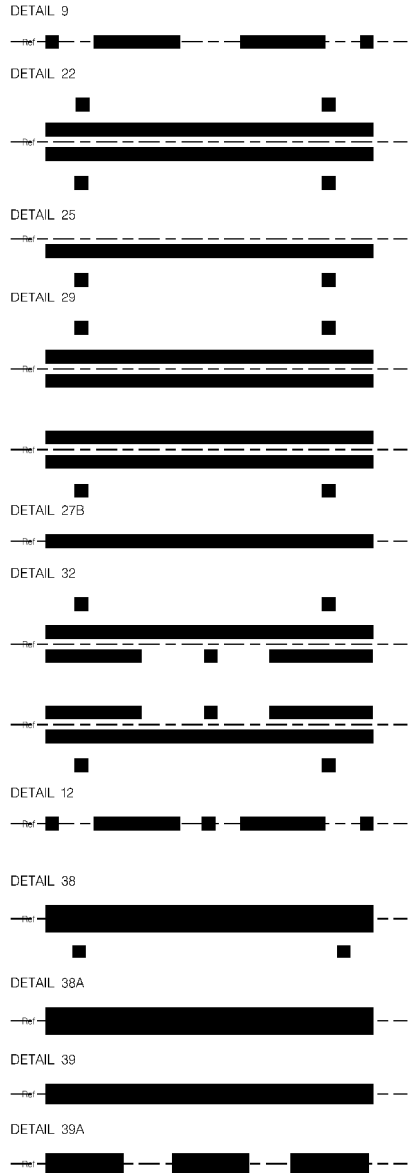

ABBREVIATIONS

LF	LINEAR FEET
TYP.	TYPICAL
CR	CURB RETURN

DISCIPLINE CODE

T	TRAFFIC
E	ELECTRICAL

SPEC. NO.



CONTRACTOR
INSPECTOR

MISSION VILLAGE DRIVE
STRIPING, SIGNING &
ELECTRICAL PLAN

LIMITS/FRIARS ROAD TO GRAMERCY DR

CITY OF SAN DIEGO, CALIFORNIA TRANSPORTATION DEPARTMENT SHEET 1 OF 17 SHEETS				WATER WBS	N/A
APPROVED BY: <i>Brian Genovese</i> FOR CITY ENGINEER: Brian Genovese DATE: 12-23-2021 C-57979				SEWER WBS	N/A
SUBMITTED BY: AHMAD ERIKAT PROJECT MANAGER				CHECKED BY: JOHN MARTIN NORTON PROJECT ENGINEER	
DESCRIPTION				CCS27 COORDINATE	
ORIGINAL				CCS83 COORDINATE	
DATE STARTED				DATE COMPLETED	

CONSTRUCTION CHANGE / ADDENDUM

CHANGE	DATE	AFFECTED OR ADDED SHEET NUMBERS	APPROVAL NO.

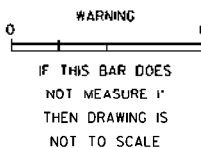

Transportation
Department

DETAILS & LEGEND

LEGEND

STRIPING DETAIL PER CA MUTCD FIGURES 3A 101 (CA) THROUGH 3A 113 (CA)

PAVEMENT ARROW TYPE IV (L) PER CALTRANS STANDARD PLAN A24A

PAVEMENT ARROW TYPE IV (R) PER CALTRANS STANDARD PLAN A24A

PAVEMENT ARROW TYPE VI (R) PER CALTRANS STANDARD PLAN A24A

SHARED LANE MARKING PER CALTRANS STANDARD PLAN A21C

SHARED LANE MARKING PER CALTRANS STANDARD PLAN A21C

EXISTING TRAFFIC SIGN

PROPOSED TRAFFIC SIGN

EXISTING LIGHT POLE

EXISTING TRAFFIC SIGNAL

TYPE E MODIFIED DETECTOR LOOP

TYPE E DETECTOR LOOP

TYPE Q BICYCLE DETECTOR LOOP

PROPOSED STRIPING/PAVEMENT MARKINGS

EXISTING STRIPING/PAVEMENT MARKINGS

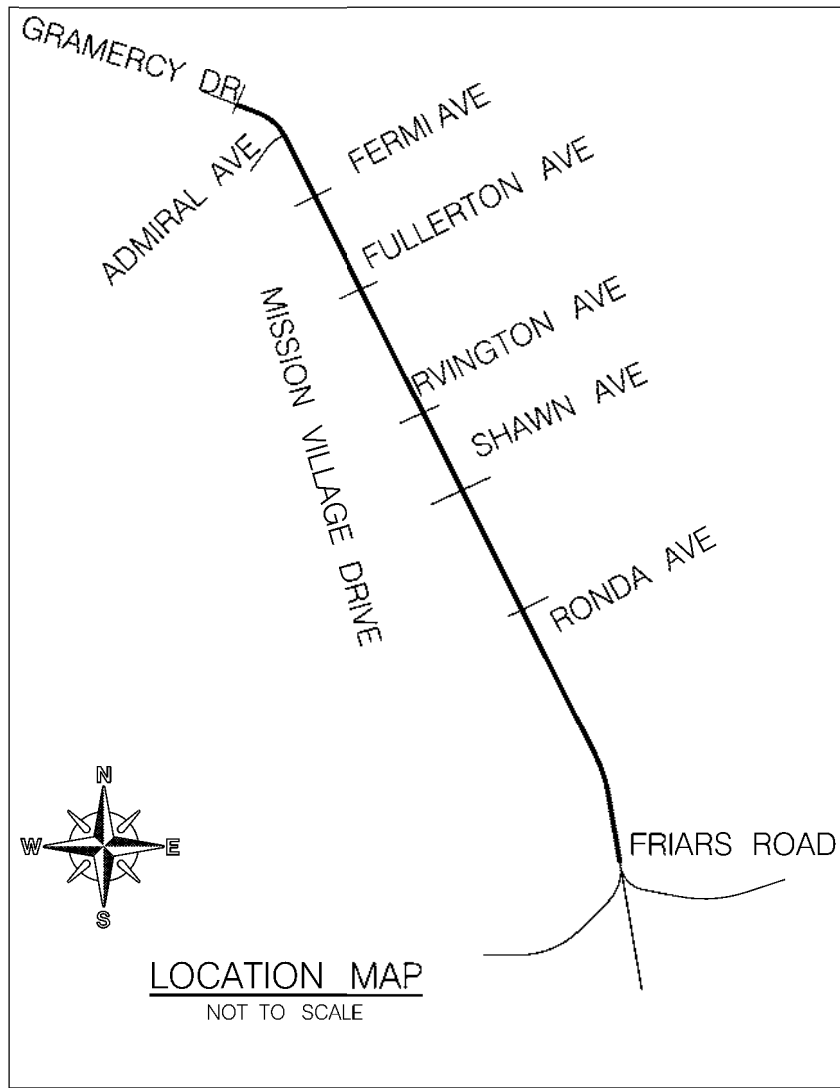
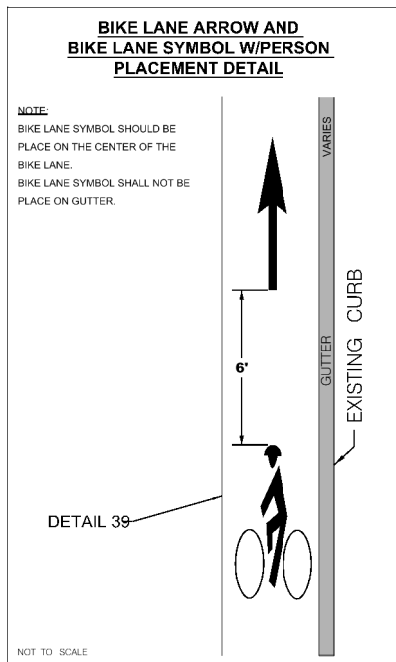
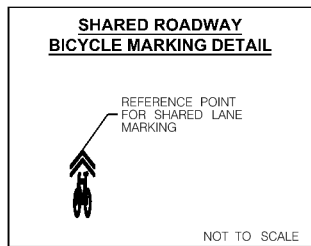
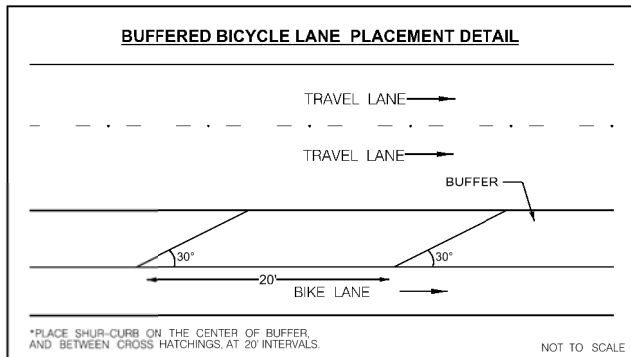
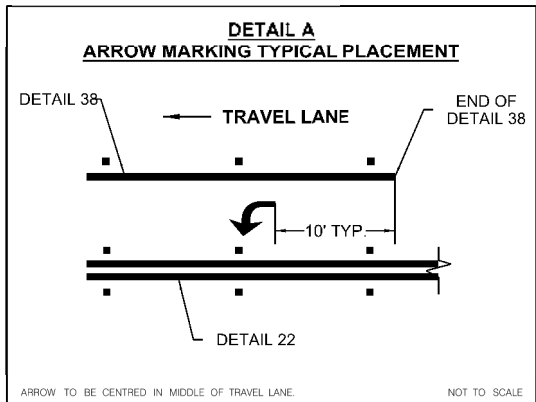

SIGN CHART

W4-2

R8-1 (CA)

W9-1

R4-1

W1-2A

NOT TO SCALE

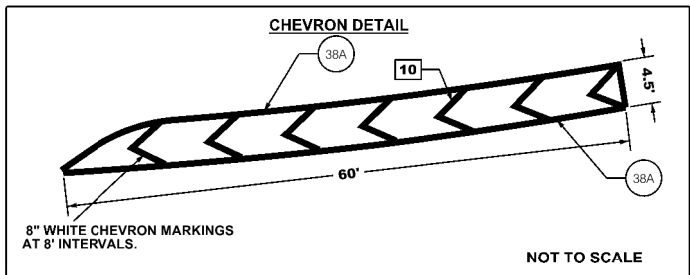

T-2

SPEC. NO.		CITY OF SAN DIEGO, CALIFORNIA TRANSPORTATION DEPARTMENT SHEET 2 OF 17 SHEETS		WATER WBS: N/A SEWER WBS: N/A	
APPROVED BY:		DATE: 12-23-2021		SUBMITTER: AHMAD ERIKAT PROJECT MANAGER	
FOR CITY ENGINEER: Brian Genovese		C-57979		CHECKED BY: JOHN MART NORIEGA PROJECT ENGINEER	
DESCRIPTION		BY	APPROVED	DATE	FILMED
ORIGINAL		JUN		12/23/21	
CONTRACTOR		DATE STARTED			
INSPECTOR		DATE COMPLETED			

REMOVAL

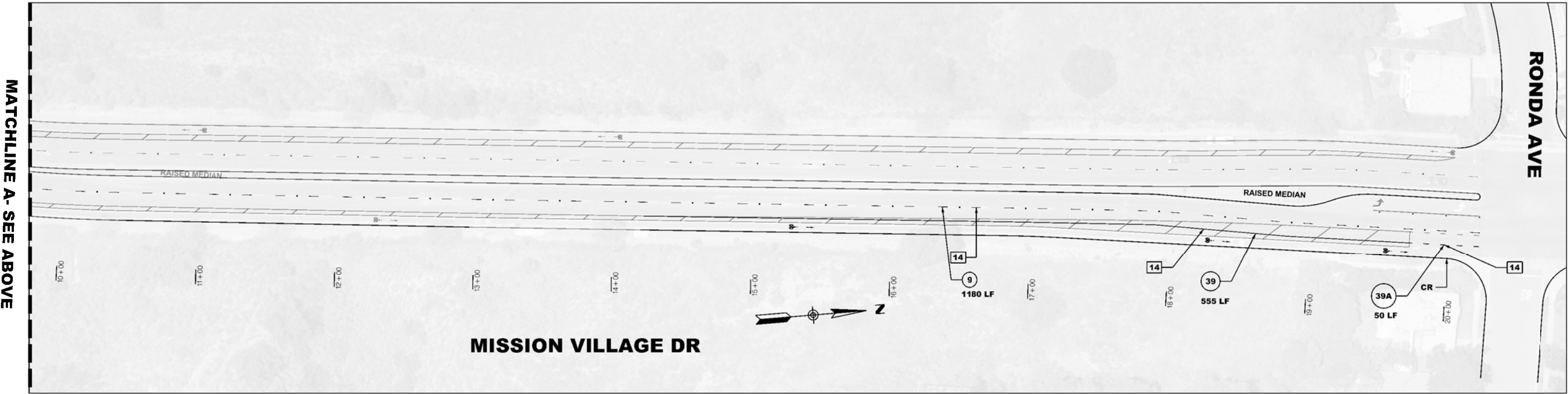
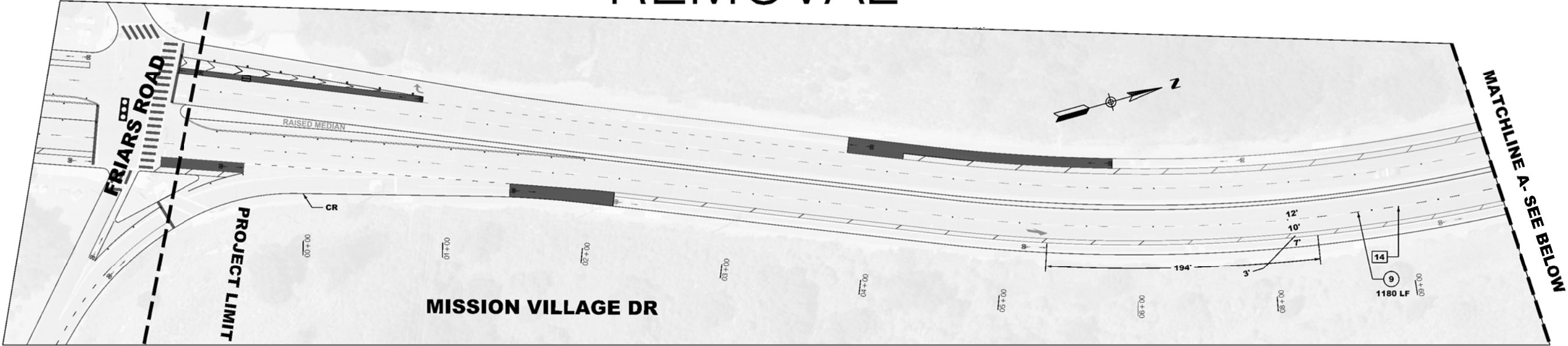

STRIPING CONSTRUCTION NOTES

14 REMOVE EXISTING STRIPING DETAIL.



T-3

MISSION VILLAGE DRIVE

STRIPING REMOVAL PLAN

LIMITS: FRIARS ROAD (STA. 0+00) TO GRAMERCY DR (STA. 20+00)

SPEC. NO.	CITY OF SAN DIEGO, CALIFORNIA		WATER WBS		N/A
	TRANSPORTATION DEPARTMENT		SEWER WBS		N/A
SHEET 3 OF 17 SHEETS		DATE		12-23-2021	
FOR CITY ENGINEER		DEPUTY CITY ENGINEER		C-57979	
DESCRIPTION		BY	APPROVED	DATE	FILMED
ORIGINAL		JUN		12/23/21	
CONTRACTOR		DATE STARTED			
INSPECTOR		DATE COMPLETED			
SUBMITTED BY		PROJECT MANAGER		AHMAD, ERIKAT	
CHECKED BY		PROJECT ENGINEER		JOHN, MARI NOREGA	
		CCS27 COORDINATE			
		CCS83 COORDINATE			

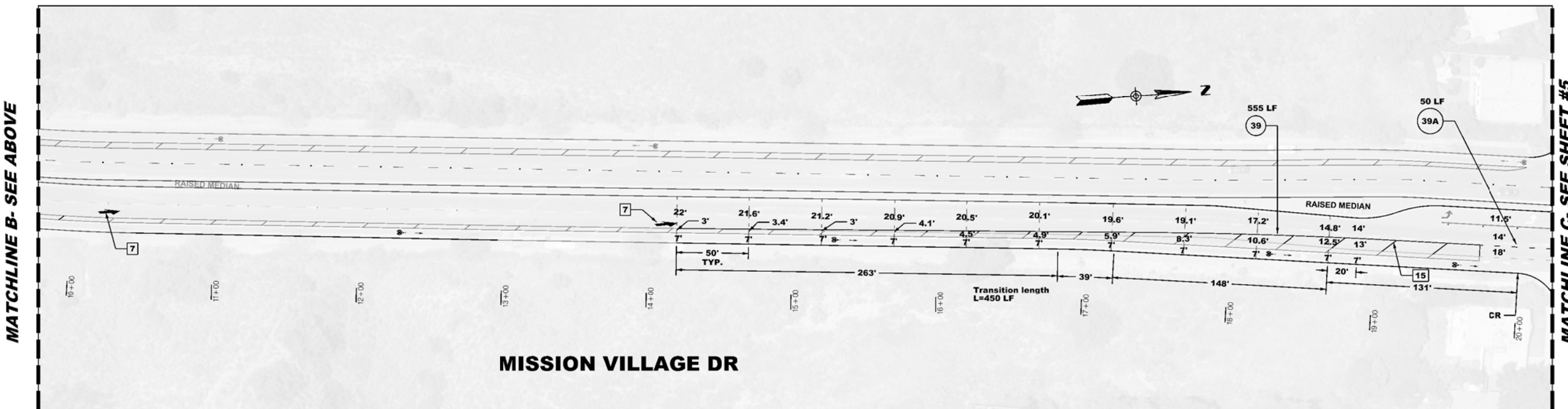
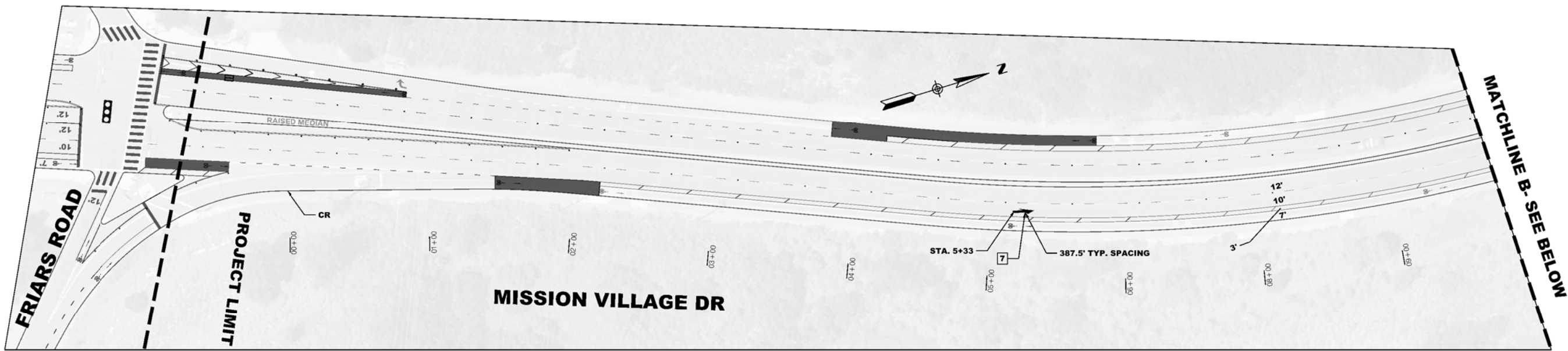

STRIPING CONSTRUCTION NOTES

- 7 INSTALL PAVEMENT ARROW TYPE VI (R) PER CALTRANS STANDARD PLAN A24A, IN CENTER OF TRAVEL LANE.
- 15 INSTALL WHITE PAINT TO EXTEND CROSS HATCHING TO NEW PROPOSED DETAIL 39.



SPEC. NO.		CITY OF SAN DIEGO, CALIFORNIA TRANSPORTATION DEPARTMENT SHEET 4 OF 17 SHEETS				WATER WBS N/A SEWER WBS N/A	
APPROVED BY <i>Brian Genovese</i> FOR CITY ENGINEER Brian Genovese DEPUTY CITY ENGINEER		DATE 12-23-2021		PROJECT MANAGER AHMAD, EBRAHIM		PROJECT ENGINEER JOHN, MARTIN	
DESCRIPTION		BY	APPROVED	DATE	FILMED	CCS27 COORDINATE	
ORIGINAL		JMN		12/23/21		CCS83 COORDINATE	
CONTRACTOR		DATE STARTED		DATE COMPLETED			
INSPECTOR							

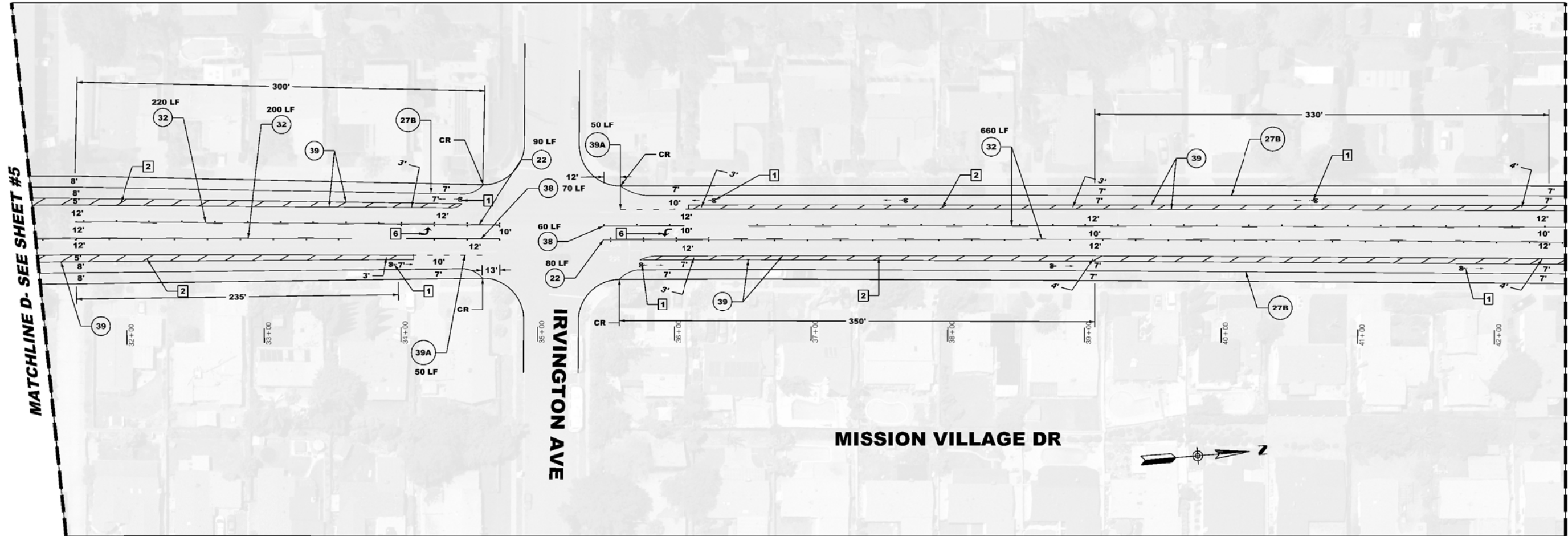

STRIPING CONSTRUCTION NOTES

- 1 INSTALL BIKE LANE ARROW AND BIKE SYMBOL WITH PERSON, PER CALTRANS STANDARD PLAN A24A, AT 300' INTERVALS OR AS SHOWN PER PLAN. BIKE LANE ARROW OR BIKE LANE SYMBOL WITH PERSON SHOULD NOT BE PLACED IN GUTTER PAN, WHERE PRESENT.
- 2 INSTALL 6" WHITE DIAGONAL CROSS HATCHING THERMOPLASTIC 125 MIL. STRIPE, ANGLED AT 30 DEGREES AND AT 20' INTERVALS. SEE BUFFERED BICYCLE LANE DETAIL.
- 6 INSTALL PAVEMENT ARROW TYPE IV (L) PER CALTRANS STANDARD PLAN A24A, IN CENTER OF TRAVEL LANE.



T-6

MISSION VILLAGE DRIVE

STRIPING PLAN

LIMITS/FRIARS ROAD (STA. 32+00) TO GRAMERCY DR (STA. 42+00)

SPEC. NO.	CITY OF SAN DIEGO, CALIFORNIA TRANSPORTATION DEPARTMENT SHEET 6 OF 17 SHEETS		WATER WBS	N/A
	FOR CITY ENGINEER Brian Genovese DEPUTY CITY ENGINEER		SEWER WBS	N/A
	DATE 12-23-2021		SUBMITTED BY AHMAD, ERIKAT PROJECT MANAGER	
	C-57979		CHECKED BY JOHN, MARTI NOREGA PROJECT ENGINEER	
	DESCRIPTION	BY	APPROVED	DATE
ORIGINAL	JUN		12/21/21	
CONTRACTOR			DATE STARTED	
INSPECTOR			DATE COMPLETED	
			CCS27 COORDINATE	
			CCS83 COORDINATE	

MATCHLINE E- SEE SHEET #6

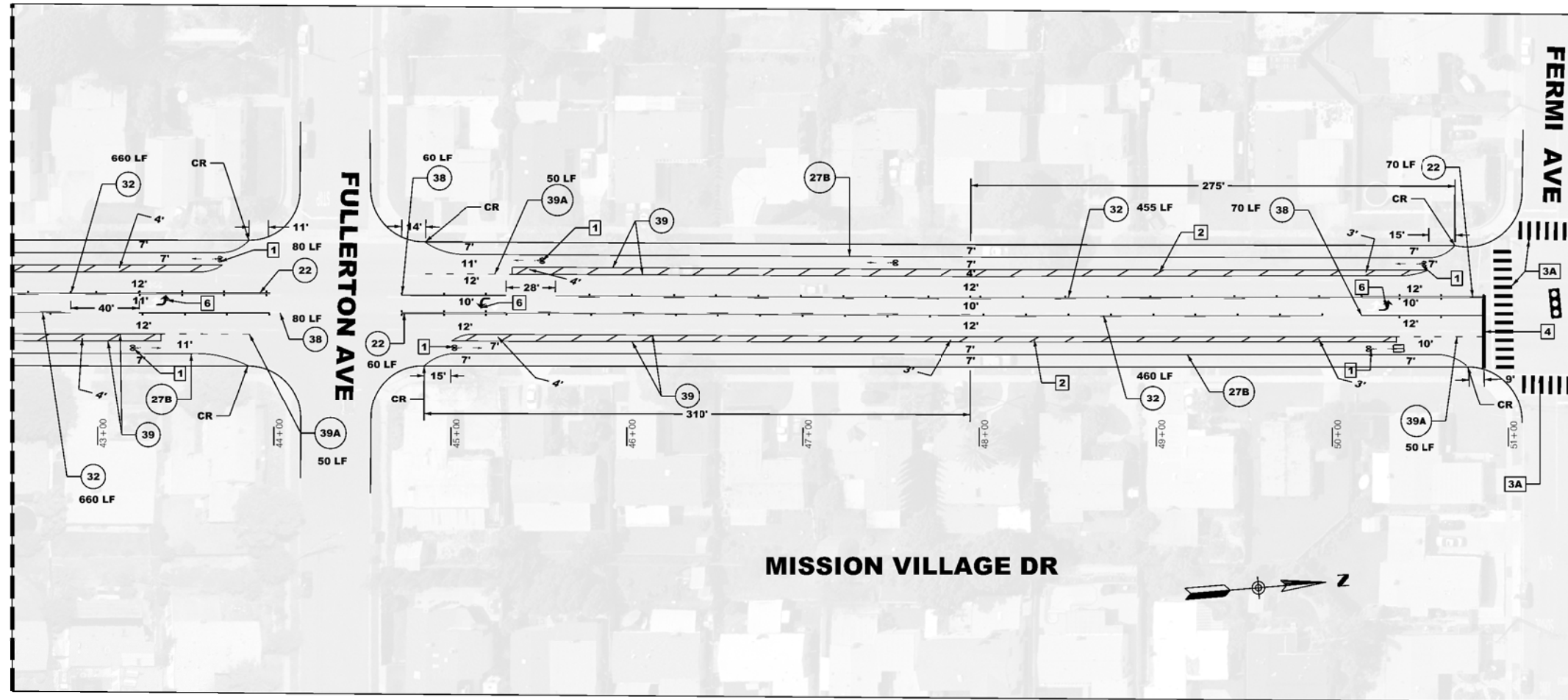

MATCHLINE F- SEE SHEET #8

STRIPING CONSTRUCTION NOTES

- 1 INSTALL BIKE LANE ARROW AND BIKE SYMBOL WITH PERSON, PER CALTRANS STANDARD PLAN A24A, AT 300' INTERVALS OR AS SHOWN PER PLAN. BIKE LANE ARROW OR BIKE LANE SYMBOL WITH PERSON SHOULD NOT BE PLACED IN GUTTER PAN, WHERE PRESENT.
- 2 INSTALL 6" WHITE DIAGONAL CROSS HATCHING THERMOPLASTIC 125 MIL STRIPE, ANGLED AT 30 DEGREES AND AT 20' INTERVALS SEE BUFFERED BICYCLE LANE DETAIL.
- 3A INSTALL YELLOW CONTINENTAL CROSSWALK MARKINGS, PER CITY OF SAN DIEGO STANDARD DRAWING NUMBER SDM-16. ALL TRAFFIC LINES AND MARKINGS SHOULD BE A MINIMUM OF 4' FROM CONTINENTAL CROSSWALK MARKINGS. RESIDENT ENGINEER TO APPROVE CROSSWALK MARKING LAYOUT IN FIELD PRIOR TO INSTALLATION. ONLY STRIPE CONTINENTAL CROSSWALKS WITHIN RESURFACING LIMITS.
- 4 INSTALL PAVEMENT MARKING LIMIT LINE (STOP LINE) PER CALTRANS STANDARD PLAN A24E.
- 6 INSTALL PAVEMENT ARROW, TYPE IV (L) PER CALTRANS STANDARD PLAN A24A, IN CENTER OF TRAVEL LANE.

T-7

MISSION VILLAGE DRIVE

STRIPING PLAN

LIMITS/FRIARS ROAD (STA. 43+00) TO GRAMERCY DR (STA. 51+00)

SPEC. NO.	CITY OF SAN DIEGO, CALIFORNIA TRANSPORTATION DEPARTMENT SHEET 7 OF 17 SHEETS	WATER WBS SEWER WBS	N/A N/A	
APPROVED BY: <i>Brian Genovese</i> FOR CITY ENGINEER: Brian Genovese DEPUTY CITY ENGINEER: C-57979		DATE: 12-23-2021	SUBMITTED BY: AHMAD, ERIKAT PROJECT MANAGER: JOHN, MARI NOREGA PROJECT ENGINEER:	
DESCRIPTION	BY	APPROVED	DATE	FILMED
ORIGINAL	JUN		12/23/21	
CONTRACTOR		DATE STARTED		
INSPECTOR		DATE COMPLETED		



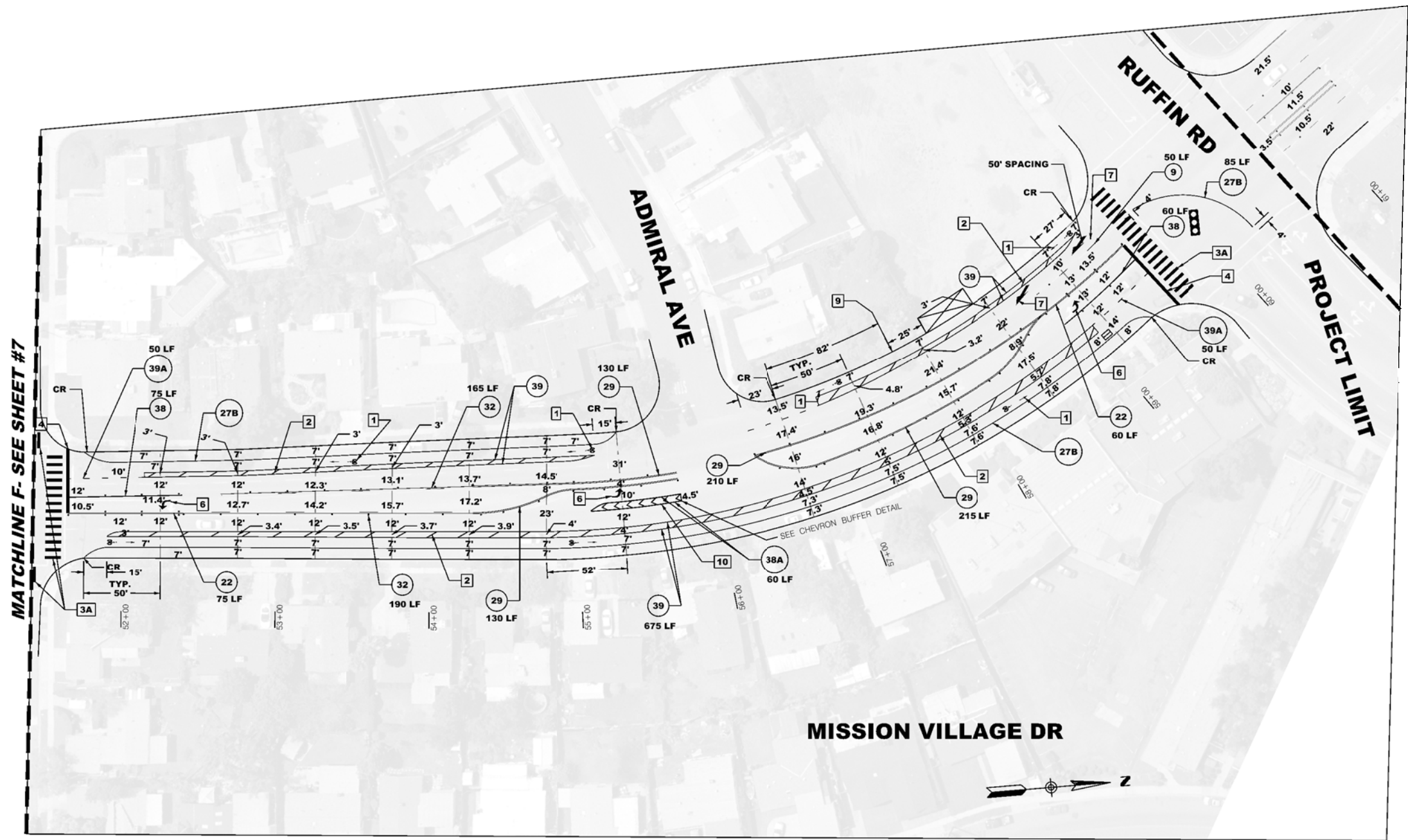

STRIPING CONSTRUCTION NOTES

- 1 INSTALL BIKE LANE ARROW AND BIKE SYMBOL WITH PERSON, PER CALTRANS STANDARD PLAN A24A. AT 300' INTERVALS OR AS SHOWN PER PLAN. BIKE LANE ARROW OR BIKE LANE SYMBOL WITH PERSON SHOULD NOT BE PLACED IN GUTTER PAN, WHERE PRESENT.
- 2 INSTALL 6" WHITE DIAGONAL CROSS HATCHING THERMOPLASTIC 125 MIL STRIP, ANGLED AT 30 DEGREES AND AT 20' INTERVALS. SEE BUFFERED BICYCLE LANE DETAIL.
- 3A INSTALL YELLOW CONTINENTAL CROSSWALK MARKINGS, PER CITY OF SAN DIEGO STANDARD DRAWING NUMBER SDM-16. ALL TRAFFIC LINES AND MARKINGS SHOULD BE A MINIMUM OF 4' FROM CONTINENTAL CROSSWALK MARKINGS. RESIDENT ENGINEER TO APPROVE CROSSWALK MARKING LAYOUT IN FIELD PRIOR TO INSTALLATION. ONLY STRIPE CONTINENTAL CROSSWALKS WITHIN RESURFACING LIMITS.
- 4 INSTALL PAVEMENT MARKING LIMIT LINE (STOP LINE) PER CALTRANS STANDARD PLAN A24E
- 6 INSTALL PAVEMENT ARROW TYPE IV (L) PER CALTRANS STANDARD PLAN A24A, IN CENTER OF TRAVEL LANE.
- 7 INSTALL PAVEMENT ARROW TYPE VI (R) PER CALTRANS STANDARD PLAN A24A, IN CENTER OF TRAVEL LANE.
- 9 INSTALL RED CURB PAVEMENT
- 10 INSTALL 8" WHITE CHEVRON MARKING AT 8' INTERVAL OR AS SHOWN ON PLAN

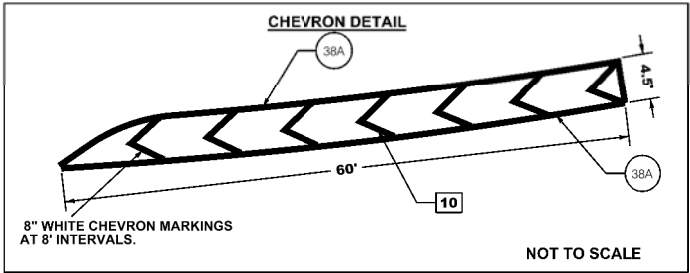

T-8

MISSION VILLAGE DRIVE

STRIPING PLAN

LIMITS/FIARS ROAD (STA. 52+00) TO GRAMERCY DR (STA. 61+00)

SPEC. NO.	CITY OF SAN DIEGO, CALIFORNIA TRANSPORTATION DEPARTMENT SHEET 8 OF 17 SHEETS	WATER WBS SEWER WBS	N/A N/A
APPROVED BY <i>Brian Genovese</i> FOR CITY ENGINEER	DATE 12-23-2021	SUBMITTED BY AHMAD, ERIKAT PROJECT MANAGER	
DEPUTY CITY ENGINEER Brian Genovese C-57979	DATE C-57979	CHECKED BY JOHN, MARI NOHEGA PROJECT ENGINEER	
DESCRIPTION	BY	APPROVED	DATE
ORIGINAL	JUN		12/23/21
CONTRACTOR	DATE STARTED		
INSPECTOR	DATE COMPLETED		
		CCS27 COORDINATE	
		CCS83 COORDINATE	

SIGN	TREATMENT					
		T-10	T-11	T-12	T-13	T-14
W9-1	INSTALL	1				1
	REMOVE					
	NEW POLES	1				1
W4-2	INSTALL	1				1
	REMOVE					
	NEW POLES	1				1
R4-1	INSTALL	1				
	REMOVE					
	NEW POLES	1				
R81(CA)	INSTALL		5	9	6	5
	REMOVE					
	NEW POLES		4	8	4	4
W1-2A	INSTALL					1
	REMOVE					
	NEW POLES					

36"

36"

W4-2

12"

8"

R81(CA)

30"

30"

W9-1

18"

24"

R4-1

36"

36"

W1-2A

SIGN CHART

NOT TO SCALE

T-9

MISSION VILLAGE DRIVE

SIGNING PLAN

SIGN AND POST DATA TABLE

SPEC. NO.	CITY OF SAN DIEGO, CALIFORNIA TRANSPORTATION DEPARTMENT SHEET 9 OF 17 SHEETS	WATER WBS SEWER WBS	N/A N/A	
<div><div><div>REGISTERED PROFESSIONAL ENGINEER</div><div>C-57979</div><div>CIVIL</div><div>STATE OF CALIFORNIA</div></div></div>	APPROVED BY Brian Genovese DEPUTY CITY ENGINEER	DATE 12-23-2021	SUBMITTED BY AHMAD ERIKAT PROJECT MANAGER	
	DESCRIPTION ORIGINAL	BY JMN	APPROVED DATE 12/23/21	FILED
CONTRACTOR INSPECTOR	DATE STARTED DATE COMPLETED		CCS27 COORDINATE CCS83 COORDINATE	

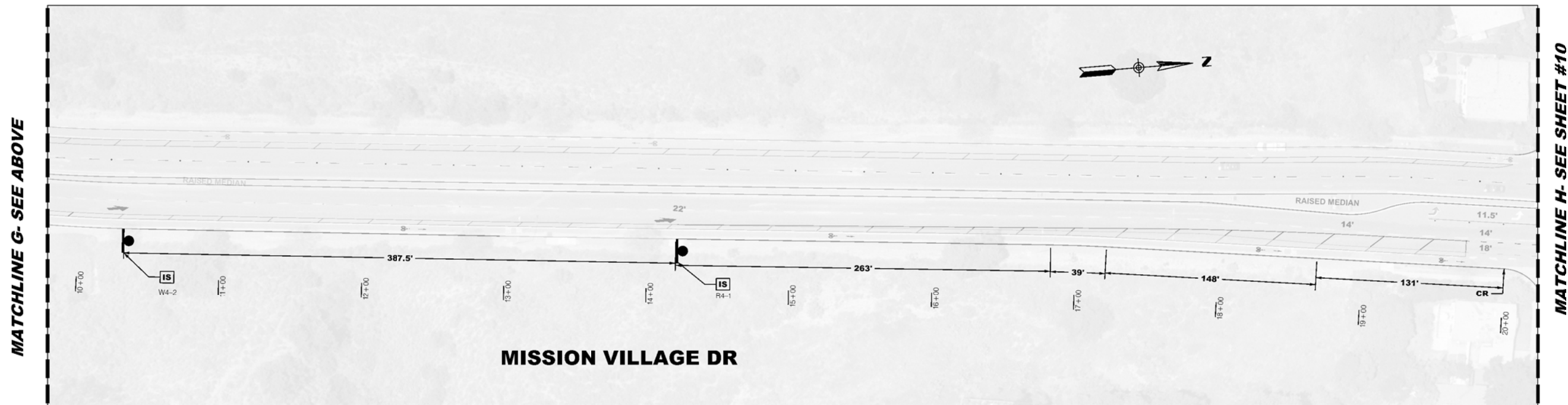
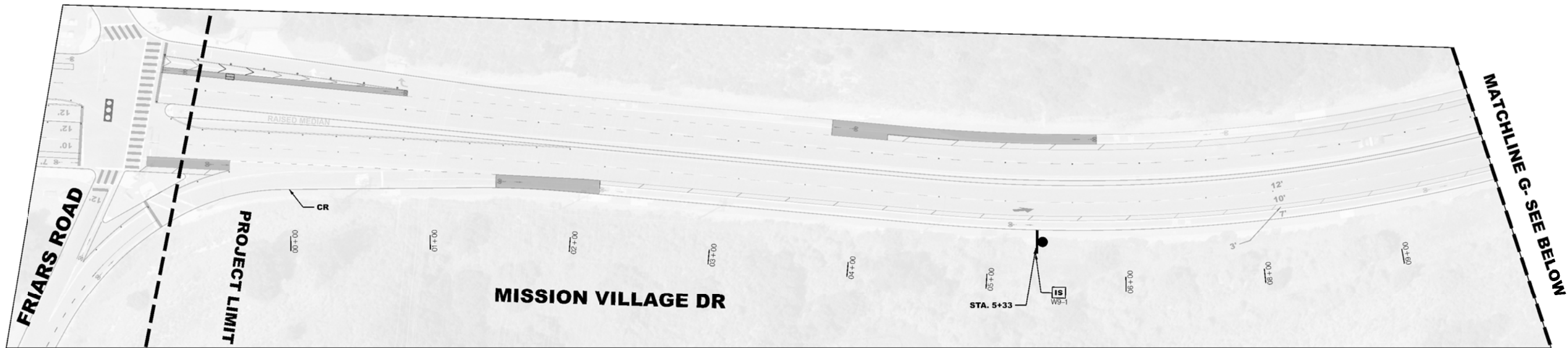

SIGNING CONSTRUCTION NOTES

IS INSTALL NEW SIGN.

SPEC. NO.		CITY OF SAN DIEGO, CALIFORNIA TRANSPORTATION DEPARTMENT SHEET 10 OF 17 SHEETS		WATER WBS N/A SEWER WBS N/A	
APPROVED BY <i>Brian Genovese</i> FOR CITY ENGINEER Brian Genovese DEPUTY CITY ENGINEER		DATE 12-23-2021 C-57979		SUBMITTED BY AHMAD, ESIKAT PROJECT MANAGER	
DESCRIPTION		BY	APPROVED	DATE	FILMED
ORIGINAL		JMN		12/23/21	
CONTRACTOR		DATE STARTED			
INSPECTOR		DATE COMPLETED			
				CCS27 COORDINATE	
				CCS83 COORDINATE	

T-10

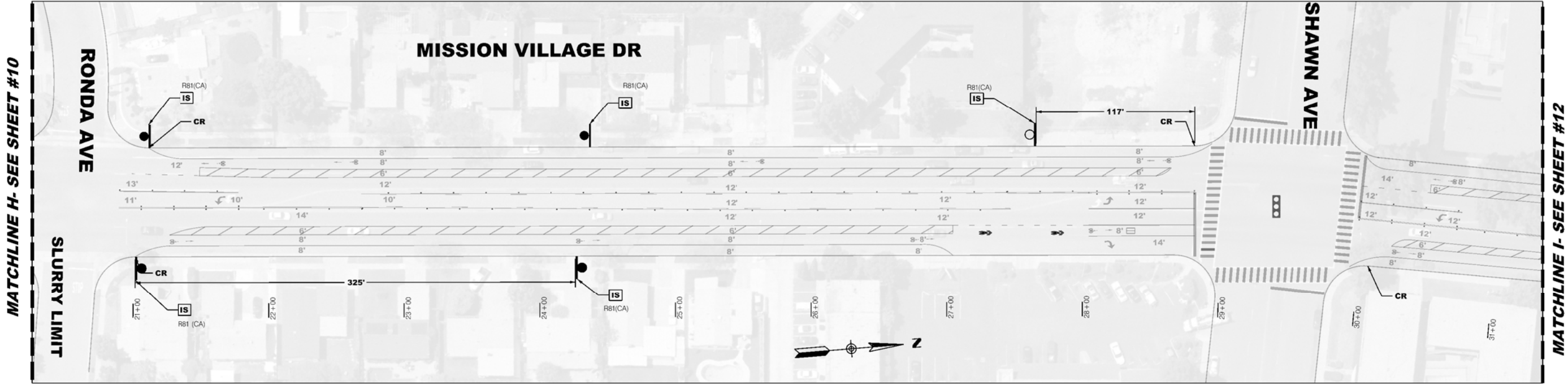

SIGNING CONSTRUCTION NOTES

[IS] INSTALL NEW SIGN.



T-11

MISSION VILLAGE DRIVE				
SIGNING PLAN				
LIMITS/FRIARS ROAD (STA. 20+00) TO GRAMERCY DR (STA. 31+00)				
SPEC. NO.	CITY OF SAN DIEGO, CALIFORNIA TRANSPORTATION DEPARTMENT SHEET 11 OF 17 SHEETS			
WATER WBS	N/A			
SEWER WBS	N/A			
DESIGNED BY	12-23-2021			
FOR CITY ENGINEER	DATE			
Brian Genovese	C-57979			
DEPUTY CITY ENGINEER	SEAL			
DESCRIPTION	BY	APPROVED	DATE	FILED
ORIGINAL	JUN		12/23/21	
CONTRACTOR	DATE STARTED			
INSPECTOR	DATE COMPLETED			
SUBMITTED BY: AHMAD, ERIKAT PROJECT MANAGER				
CHECKED BY: JOHN, MARI NOREGA PROJECT ENGINEER				
CCS27 COORDINATE				
CCS83 COORDINATE				

MATCHLINE I- SEE SHEET #11

MATCHLINE J- SEE SHEET #13

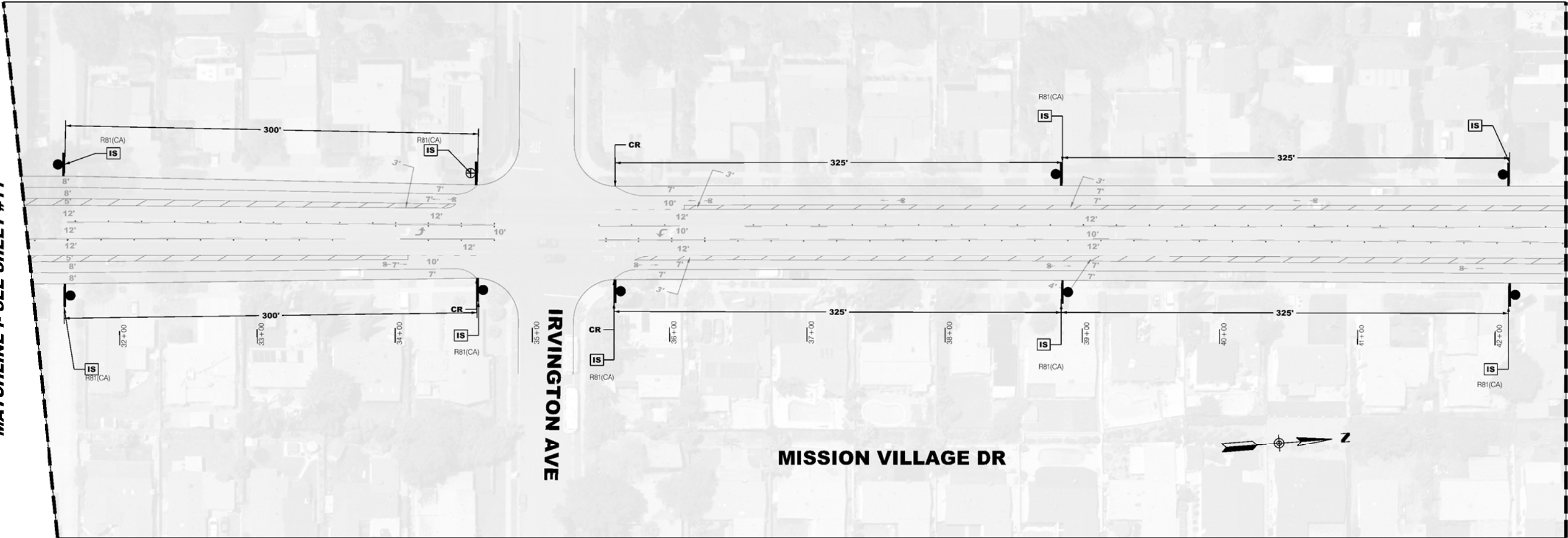

SIGNING CONSTRUCTION NOTES

[IS] INSTALL NEW SIGN.

T-12

MISSION VILLAGE DRIVE

SIGNING PLAN

LIMITS/FRIARS ROAD (STA. 32+00) TO GRAMERCY DR (STA. 42+00)

SPEC. NO.	CITY OF SAN DIEGO, CALIFORNIA TRANSPORTATION DEPARTMENT SHEET 12 OF 17 SHEETS		WATER WBS	N/A	
			SEWER WBS	N/A	
	APPROVED BY: <i>Brian Genovese</i> FOR CITY ENGINEER: Brian Genovese DEPUTY CITY ENGINEER: C-57979		DATE: 12-23-2021		
	DESCRIPTION	BY	APPROVED	DATE	FILMED
ORIGINAL		JMN	12/23/21		
CONTRACTOR		DATE STARTED			
INSPECTOR		DATE COMPLETED			
		SUBMITTED BY: AHMAD, ERIKAT PROJECT MANAGER			
		CHECKED BY: JOHN, MARI NOREGA PROJECT ENGINEER			
		CCS27 COORDINATE			
		CCS83 COORDINATE			



MATCHLINE J- SEE SHEET #12

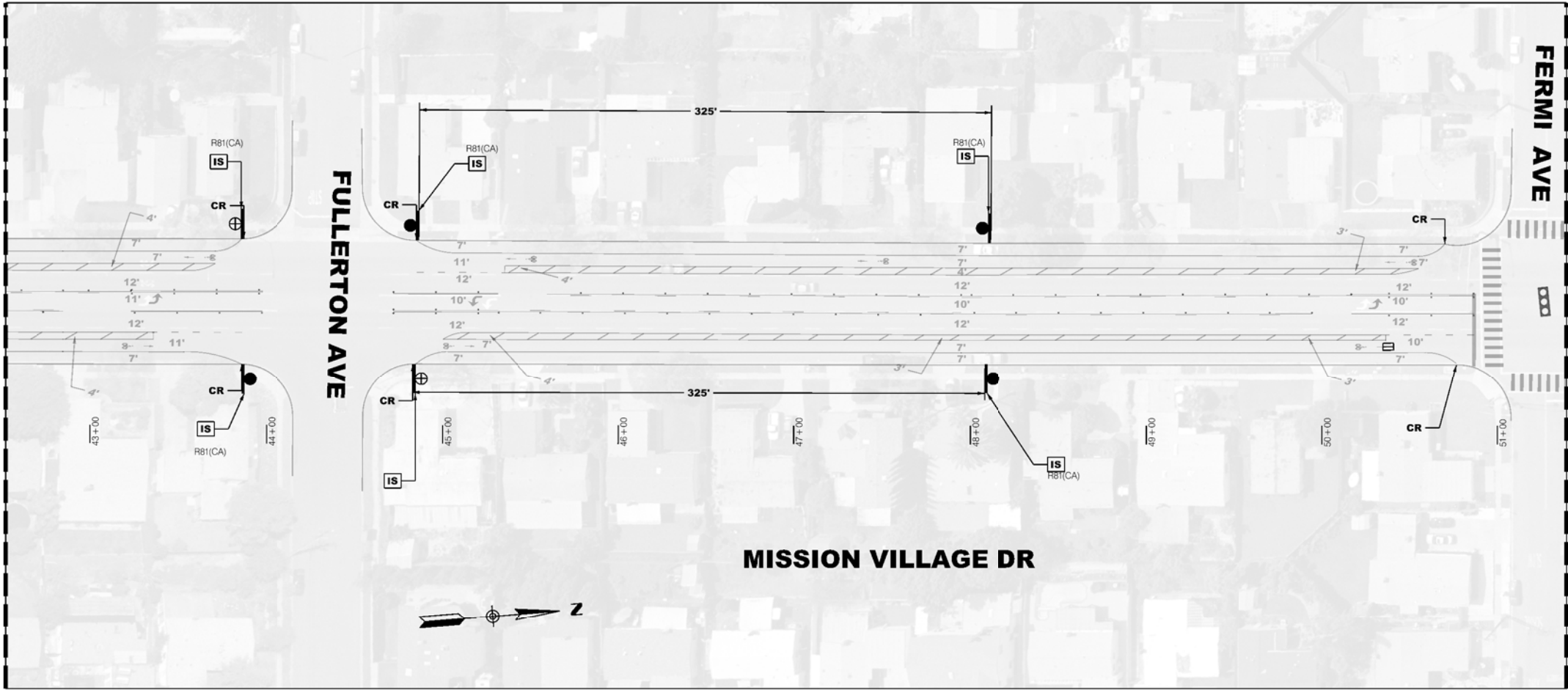

MATCHLINE K- SEE SHEET #14

SIGNING CONSTRUCTION NOTES

[IS] INSTALL NEW SIGN.



T-13

MISSION VILLAGE DRIVE

SIGNING PLAN

LIMITS/FRIARS ROAD (STA. 43+00) TO GRAMERCY DR (STA. 51+00)

SPEC. NO.	CITY OF SAN DIEGO, CALIFORNIA TRANSPORTATION DEPARTMENT SHEET 13 OF 17 SHEETS	WATER WBS SEWER WBS	N/A N/A	
APPROVED BY: <i>Brian Genovese</i> FOR CITY ENGINEER: Brian Genovese DEPUTY CITY ENGINEER		DATE: 12-23-2021	SUBMITTED BY: AHMAD, ERIKAT PROJECT MANAGER	
C-57979		DATE: 12-23-2021	CHANGED BY: JOHN, MARI NOHEGA PROJECT ENGINEER	
DESCRIPTION	BY	APPROVED	DATE	FILMED
ORIGINAL	JMN		12/23/21	
CONTRACTOR		DATE STARTED		
INSPECTOR		DATE COMPLETED		

MATCHLINE K- SEE SHEET #13

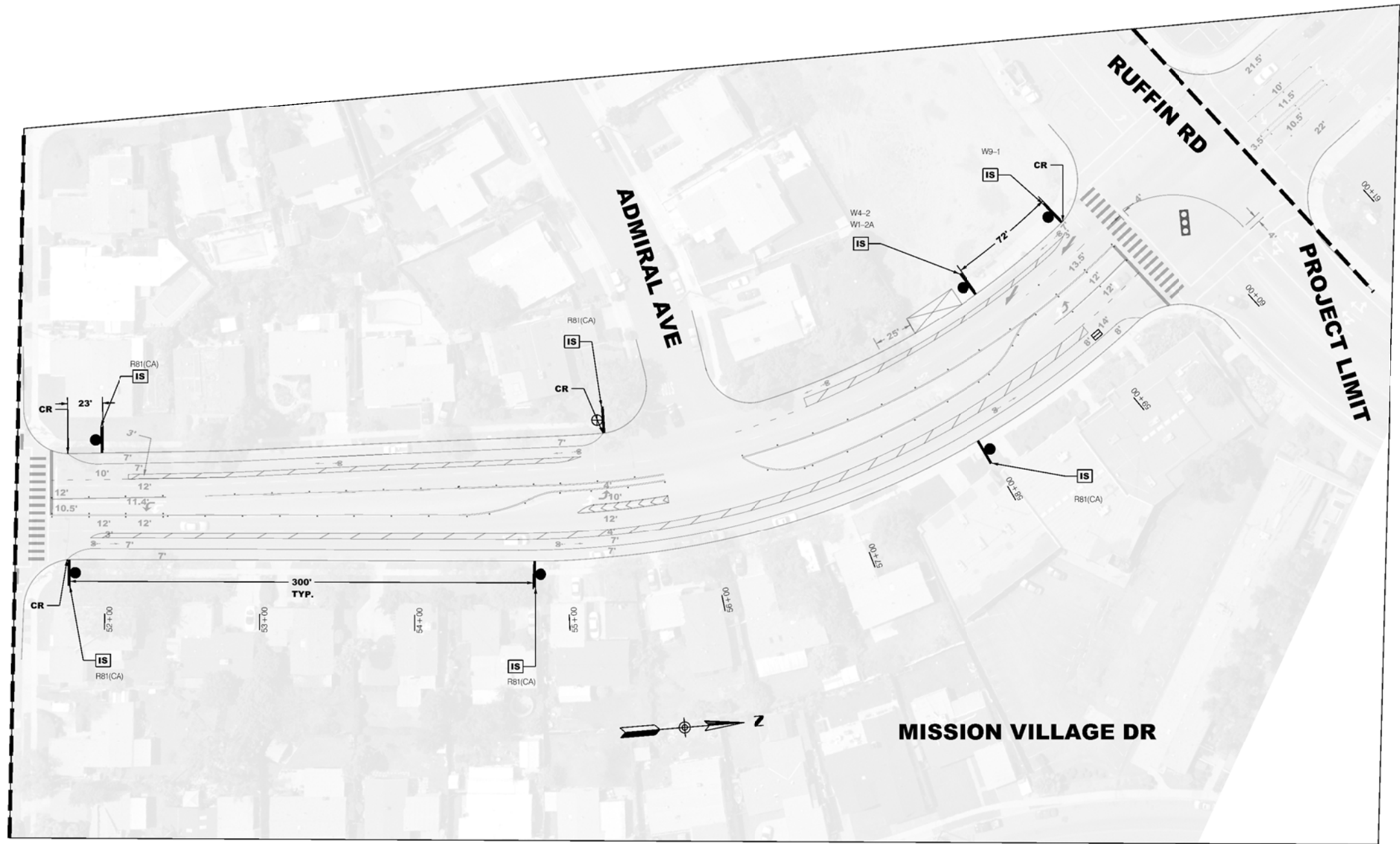

SIGNING CONSTRUCTION NOTES

[IS] INSTALL NEW SIGN.



T-14

MISSION VILLAGE DRIVE

SIGNING PLAN

LIMITS/FRIARS ROAD (STA. 52+00) TO GRAMERCY DR (STA. 61+00)

SPEC. NO.	CITY OF SAN DIEGO, CALIFORNIA TRANSPORTATION DEPARTMENT SHEET 14 OF 17 SHEETS	WATER WBS SEWER WBS	N/A N/A
APPROVED BY: <i>Brian Genovese</i> FOR CITY ENGINEER: Brian Genovese DEPUTY CITY ENGINEER		DATE: 12-23-2021	SUBMITTED BY: AHMAD, ERIKAT PROJECT MANAGER
DESCRIPTION		BY	APPROVED
ORIGINAL	JUN	12/23/21	
CONTRACTOR		DATE STARTED	
INSPECTOR		DATE COMPLETED	
			CCS27 COORDINATE
			CCS83 COORDINATE

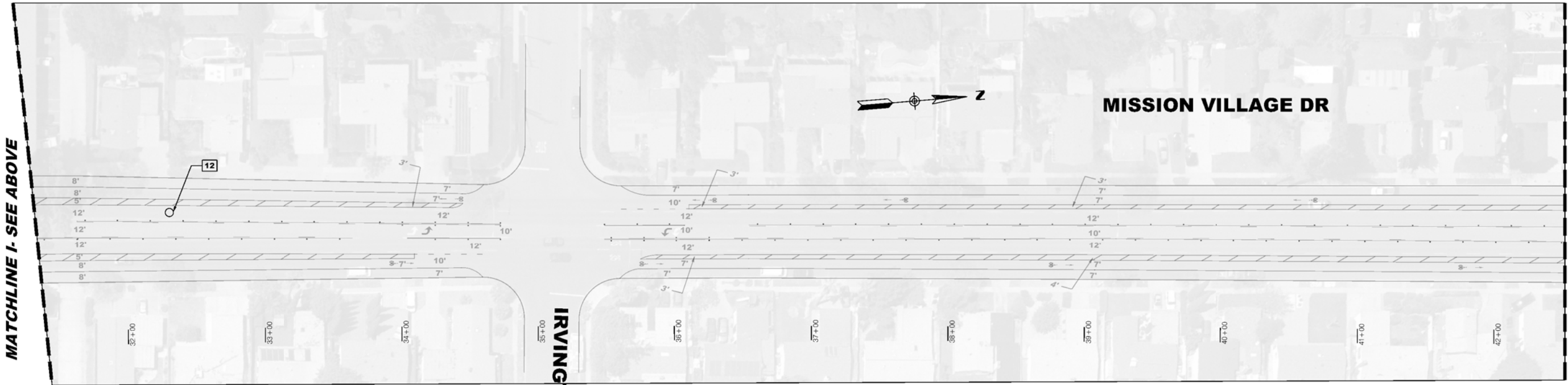
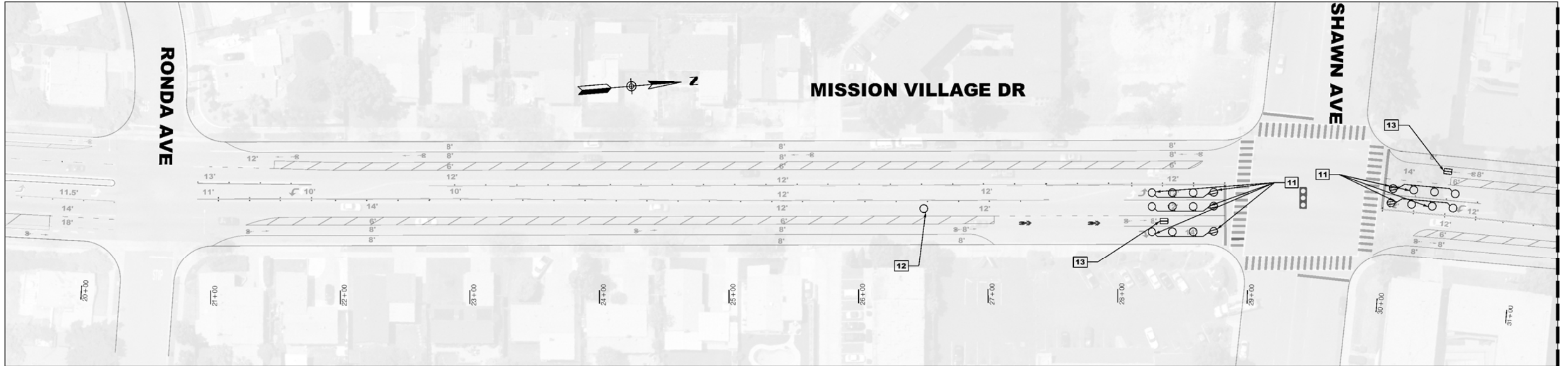

ELECTRICAL CONSTRUCTION NOTES (THIS SHEET)

- 11 REPLACE EXISTING LOOPS WITH NEW TYPE F (MOD) DETECTOR LOOPS PER THE CITY OF SAN DIEGO- STANDARD DRAWING SDE 104 AND NEW TYPE F DETECTOR LOOPS PER CALTRANS LOOP DETECTOR CONFIGURATION STANDARD PLAN ES 5B AS SHOWN ON PLAN
- 12 INSTALL NEW TYPE E DETECTOR LOOPS PER CALTRANS LOOP DETECTOR CONFIGURATION STANDARD PLAN ES 5B 230' FROM LIMIT LINE FOR ADVANCED DETECTION AS SHOWN ON PLAN.
- 13 INSTALL TYPE Q BICYCLE DETECTOR LOOP, AND DETECTOR LEAD IN CABLE (DLC) FOR EVERY NEW BICYCLE LOOP DETECTOR TO THE CONTROLLER CABINET, PER CALTRANS STANDARD PLAN ES 5B, AT 44' IN ADVANCE OF LIMIT LINE, OR AS SHOWN PER PLAN. CONTRACTOR TO ENSURE ALL NECESSARY WORK IS COMPLETED TO MAKE NEW LOOP(S) OPERATIONAL.

E-1

MISSION VILLAGE DRIVE

ELECTRICAL PLAN

LIMITS/FRIARS ROAD (STA. 20+00) TO GRAMERCY DR (STA. 42+00)

SPEC. NO.	CITY OF SAN DIEGO, CALIFORNIA TRANSPORTATION DEPARTMENT SHEET 15 OF 17 SHEETS	WATER WBS SEWER WBS	N/A N/A
	APPROVED BY <i>Brian Genovese</i> FOR CITY ENGINEER Brian Genovese DEPUTY CITY ENGINEER	DATE 12-23-2021	SUBMITTED BY AHMAD, ERIKAT PROJECT MANAGER
	DESCRIPTION ORIGINAL	BY JMN	DATE 12/23/21
	APPROVED	DATE	FILMED
	CONTRACTOR INSPECTOR	DATE STARTED DATE COMPLETED	CCS27 COORDINATE CCS83 COORDINATE

MATCHLINE J- SEE SHEET #15



MATCHLINE K- SEE SHEET #17

ELECTRICAL CONSTRUCTION NOTES (THIS SHEET)

- 11 REPLACE EXISTING LOOPS WITH NEW TYPE E (MOD) DETECTOR LOOPS PER THE CITY OF SAN DIEGO- STANDARD DRAWING SCE-104 AND NEW TYPE E DETECTOR LOOPS PER CALTRANS LOOP DETECTOR CONFIGURATION STANDARD PLAN ES 5B AS SHOWN ON PLAN
- 12 INSTALL NEW TYPE E DETECTOR LOOPS PER CALTRANS LOOP DETECTOR CONFIGURATION STANDARD PLAN ES 5B 230' FROM LIMIT LINE FOR ADVANCED DETECTION AS SHOWN ON PLAN.
- 13 INSTALL TYPE Q BICYCLE DETECTOR LOOP AND DETECTOR LEAD IN CABLE (DLC) FOR EVERY NEW BICYCLE LOOP DETECTOR TO THE CONTROLLER CABINET PER CALTRANS STANDARD PLAN ES 5B AT 44' IN ADVANCE OF LIMIT LINE OR AS SHOWN PER PLAN. CONTRACTOR TO ENSURE ALL NECESSARY WORK IS COMPLETED TO MAKE NEW LOOP(S) OPERATIONAL.

E-2

MISSION VILLAGE DRIVE

ELECTRICAL PLAN

LIMITS/FRIARS ROAD(STA. 43+00) TO GRAMERCY DR (STA. 51+00)

SPEC. NO.	CITY OF SAN DIEGO, CALIFORNIA TRANSPORTATION DEPARTMENT SHEET 16 OF 17 SHEETS	WATER WBS SEWER WBS	N/A N/A			
	APPROVED BY <i>Brian Genovese</i> FOR CITY ENGINEER Brian Genovese DEPUTY CITY ENGINEER	DATE 12-23-2021	SUBMITTED BY AHMAD, ERIKAT PROJECT MANAGER			
	DESCRIPTION	BY	APPROVED	DATE	FILMED	CHANGED BY JOHN, MARI NOREGA PROJECT ENGINEER
	ORIGINAL	JUN		12/23/21		
CONTRACTOR	DATE STARTED					
INSPECTOR	DATE COMPLETED					

MATCHLINE K- SEE SHEET #16

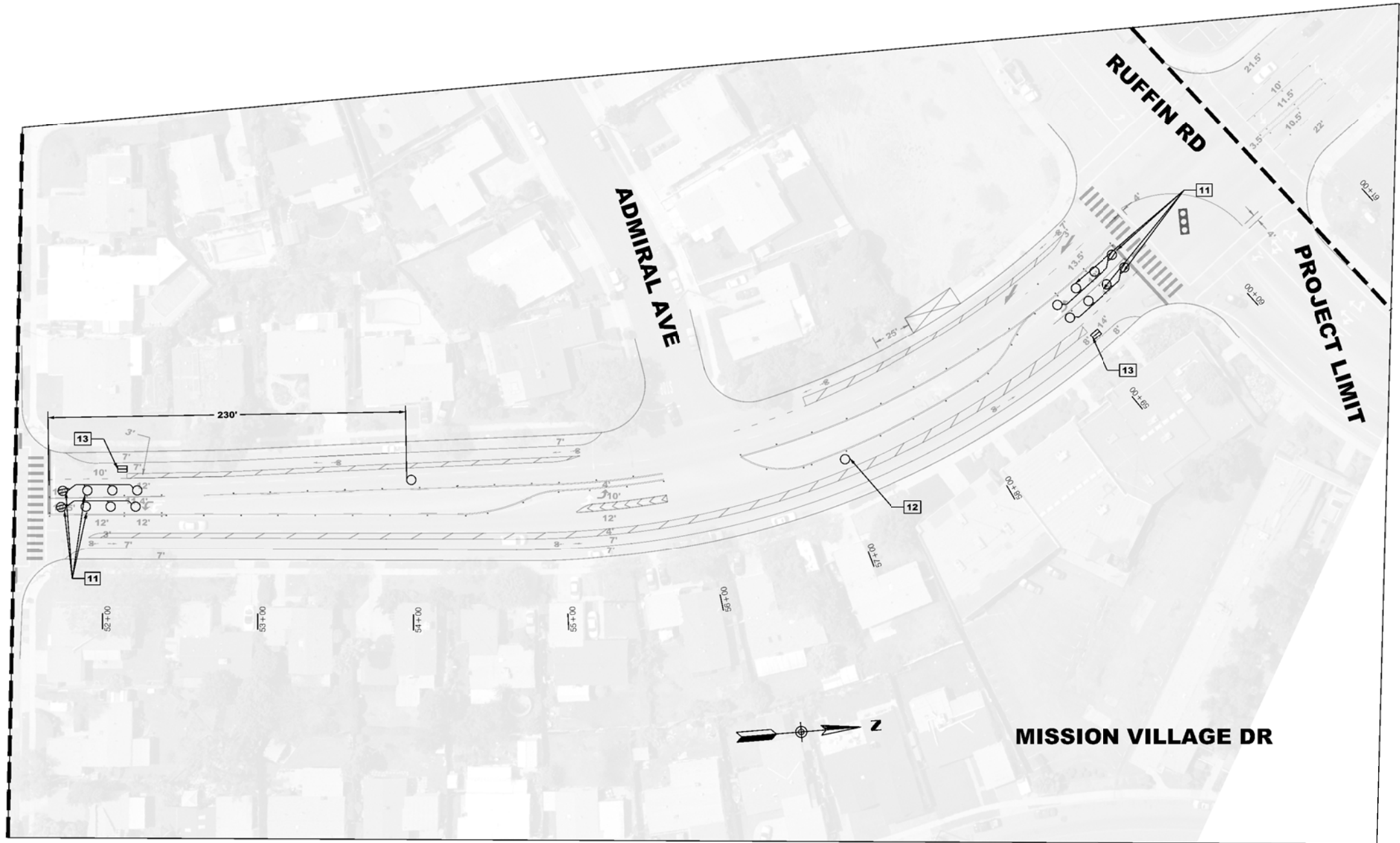

ELECTRICAL CONSTRUCTION NOTES (THIS SHEET)

- 11 REPLACE EXISTING LOOPS WITH NEW TYPE E (MOD) DETECTOR LOOPS PER THE CITY OF SAN DIEGO- STANDARD DRAWING SDE-1C4 AND NEW TYPE E DETECTOR LOOPS PER CALTRANS LOOP DETECTOR CONFIGURATION STANDARD PLAN ES 5B AS SHOWN ON PLAN
- 12 INSTALL NEW TYPE F DETECTOR LOOPS PER CALTRANS LOOP DETECTOR CONFIGURATION STANDARD PLAN ES-5B 230' FROM LIMIT LINE FOR ADVANCED DETECTION AS SHOWN ON PLAN.
- 13 INSTALL TYPE Q BICYCLE DETECTOR LOOP, AND DETECTOR LEAD IN CABLE (DLC) FOR EVERY NEW BICYCLE LOOP DETECTOR TO THE CONTROLLER CABINET, PER CALTRANS STANDARD PLAN ES 5B, AT 44' IN ADVANCE OF LIMIT LINE OR AS SHOWN PER PLAN CONTRACTOR TO ENSURE ALL NECESSARY WORK IS COMPLETED TO MAKE NEW LOOP(S) OPERATIONAL.

E-3

MISSION VILLAGE DRIVE

ELECTRICAL PLAN

LIMITS/FRIARS ROAD (STA. 52+00) TO GRAMERCY DR (STA. 61+00)

SPEC. NO.	CITY OF SAN DIEGO, CALIFORNIA TRANSPORTATION DEPARTMENT SHEET 17 OF 17 SHEETS	WATER WBS SEWER WBS	N/A N/A		
	APPROVED BY <i>Brian Genovese</i> FOR CITY ENGINEER	DATE 12-23-2021	SUBMITTED BY AHMAD, ERIKAT PROJECT MANAGER		
	Brian Genovese DEPUTY CITY ENGINEER	C-57979 SEAL	CHIEF OF JOHN, MARI NOHEGA PROJECT ENGINEER		
	DESCRIPTION	BY	APPROVED	DATE	FILMED
	ORIGINAL	JUN		12/23/21	
CONTRACTOR		DATE STARTED			
INSPECTOR		DATE COMPLETED			
				CCS27 COORDINATE	
				CCS83 COORDINATE	